

## REQUEST FOR QUOTE – Hutton Street, Taroom Kerb and Channel & Eidsvold Theodore (Cracow Range) Kerb Installation

**RFQ # Q-2122-INF70**

### **Annexure 1**

#### **1. PROJECT OVERVIEW**

To improve stormwater water drainage and therefore vehicle safety, Banana Shire Council has identified the need to undertake the replacement of the kerb and channel on the northern side of Hutton Street between Wolsey Street and Carrabah Street, Taroom. The project includes the replacement of the existing kerb and channel with layback kerb and channel, the replacement of all of the driveway cross-overs along the affected section and the replacement of a kerb inlet. The location of the proposed works is shown in attached locality plan – SK0938 - Scope of Works – **Attachment 1**.

Additionally this project involves the installation of a Department of Transport and Main Road Type 9 kerb on Eidsvold Theodore Road at the Cracow Range. The location of these works in shown in the attached locality plan – SK12272 – Scope of Works – **Attachment 2**.

#### **2. SCOPE OF PROJECT**

Construction is to be undertaken on Hutton Street as per the design plans in **Attachment 3** under the supervision and management of Council's Taroom Drainage Crew Supervisor (Phillip Hoppe). **All Management Plans and materials are to be supplied by Council.**

Works and testing for the Hutton St Project are to be completed as per the requirements of the Capricorn Municipal Development Guidelines (CMDG).

Construction on Eidsvold Theodore Road is to be undertaken as per the design plans in **Attachment 4** under the supervision of Council's Taroom Drainage Crew Supervisor (Phillip Hoppe). **All works are to be completed under the management plans of the construction project currently being undertaken at the specified location with timing of the works to be scheduled to suit this project (will require disestablishment and re-establishment from the Hutton St project). Materials for this project will be supplied by Council.**

#### **2.1 PROJECT DELIVERABLES**

##### **Hutton St Kerb and Channel Replacement**

- Adherence to Council's Safety, Quality, Environmental and Traffic Management Plans during construction.
- Site Establishment
- Clearing and Grubbing
- Removal of the existing kerb and channel and removal from site to a Council designated stockpile area
- Excavation

- Preparation of subbase and base (with Council supplied materials) for under the new kerb and channel
- Installation of 200m of lay back kerb and channel (using Council's kerb machine)
- Installation of Council supplied precast kerb inlet
- Construction of 9 concrete driveway cross-overs
- Backfill
- Installation of Council supplied topsoil
- Clean-up of site

### **Eidsvold Theodore Road (Cracow Range) Kerb Installation**

- Adherence to the existing construction projects Safety, Quality, Environmental and Traffic Management Plans during construction.
- Site Establishment – from Hutton St Project
- Installation of 100m of DTMR type 9 kerb (as per DTMR Standard drawing SD1033, attached, with an AA of 25mm) using Council's kerb machine
- Disestablishment – back to Hutton St Project

## **2.2 PROJECT EXCLUSIONS (TO BE UNDERTAKEN/SUPPLIED BY COUNCIL)**

### **Hutton St Kerb and Channel Replacement**

- Project Supervision (to be undertaken by Council's Taroom Drainage Crew Supervisor Phillip Hoppe)
- Supply of all project management plans (Safety, Quality, Environment and Traffic)
- Implementation of Traffic management plan
- Materials required for Erosion and Sediment Control measures
- Supply of design plans
- Supply of Dial before you Dig information
- Cultural Heritage checks and inspections
- Design Set out Survey
- Supply of all gravel required
- Supply of Topsoil
- Supply of all concrete required
- Supply of precast Kerb inlet
- Supply of all quality testing
- Designation of stockpile area (for both new materials and spoil)
- All waste disposal costs
- Gravel Resheeting of road shoulders
- Grass seeding of disturbed area
- Collection of As Constructed information

### **Eidsvold Theodore Road (Cracow Range) Kerb Installation**

- Project Supervision (to be undertaken by Council's Taroom Drainage Crew Supervisor Phillip Hoppe)
- Supply of all project management plans (Safety, Quality, Environment and Traffic)
- Implementation of Traffic management plan
- Supply of design plans

- Cultural Heritage checks and inspections
- Design Set out Survey
- Supply of all concrete required
- Supply of all quality testing
- Designation of stockpile area
- All waste disposal costs
- Collection of As Constructed information

### 3. CONTRACT TIMEFRAMES

Item	Date
Quote Submitted:	12 <sup>th</sup> May 2022
Works to be completed by:	17 <sup>th</sup> June 2022
Invoice to be Submitted by:	No Later than 30 <sup>th</sup> June 2022

### 4. PRICE SCHEDULE

A contractor interested in submitting a quotation is required to provide a quotation to complete the following services:

## **All Rates are to be Labour and Plant only**

ITEM NUMBER	DESCRIPTION	UNIT	QTY	RATE (INCL GST)	TOTAL (INCL GST)
<b>SERVICES</b>					
<b>HUTTON STREET KERB AND CHANNEL REPLACEMENT</b>					
1101	Site Establishment	Lump Sum	1	\$	\$
2104	Demolition and Removal of existing kerb and channel (concrete spoil to be stockpiled at the Council depot)	m	200	\$	\$
2105	Saw Cut of road seal	m	35	\$	\$
3201	Road Excavation, All materials (to be left onsite)	m3	75	\$	\$
2404	Installation of lay back kerb and channel (using Council's kerb machine and Council supplied concrete) – including installation and compaction of subbase and based (Council supplied) under the kerb and channel	m	200	\$	\$
2402	Installation of driveway cross-overs (using Council supplied concrete)	each	9	\$	\$

ITEM NUMBER	DESCRIPTION	UNIT	QTY	RATE	TOTAL
	<b>SERVICES</b>			<b>(INCL GST)</b>	<b>(INCL GST)</b>
3501	Backfill (using insitu and/or Council supplied materials)	m3	12	\$	\$
3841	Install Topsoil	m3	45	\$	\$
2405	Installation of precast kerb inlet	each	1	\$	\$
<b>EIDSVOLD THEODORE ROAD (CRACOW RANGE) KERB INSTALLATION</b>					
1102	Site Establishment (from Hutton St)	Lump Sum	1	\$	\$
2405	Installation of DTMR type 9 kerb – AA 25mm (using Council's kerb machine and Council supplied concrete)	m	100.5	\$	\$
1103	Site Disestablishment (to Hutton St)	Lump Sum	1	\$	\$
	<b>Total</b>				\$

## 5. LODGEMENT OF QUOTATION

Quotations must be emailed to [quotations@banana.qld.gov.au](mailto:quotations@banana.qld.gov.au)

Quotations **are not** to be emailed or handed directly to any Council Officer as this may eliminate you from the quoting process.

Quotations close **11am Thursday the 12<sup>th</sup> May 2022**

Council reserves the right to accept late quotations.

The Council will not accept any responsibility in the event that a quotation is not received by the Closing Date

## 6. INFORMAL QUOTATION

Any Quotation may be rejected if it:

- Does not comply with the requirements of the Specification or this Form of Quotation

## 7. ACCEPTANCE OF QUOTATION

The Council is not bound to accept any Form of Quotation.

The Council reserves the right to amend the scope of the contract inclusions and may accept part of a Form of Quotation.

The proposed contractor agrees that the Form of Quotation will remain open for acceptance for a minimum period of 30 days after the Closing Time, notwithstanding that there may have been negotiations in respect of any Form of Quotation in the meantime.

## 8. IMPLEMENTATION TIMETABLE

It is Councils intention to award this work to the successful contractor by Monday 16<sup>th</sup> May 2022. Work is to commence immediately **(after approval of all submitted project plans)** unless otherwise negotiated.

Please provide schedule in table below:

Question	# of Days
If successful and notified on Monday 16 <sup>th</sup> May 2022, when could work commence?	

## 9. INSURANCE DETAILS

The proposed contractor is to complete the table below, after having regard to levels of insurance required by conditions of contract as per the Quotation

Workers Compensation or Personal Accident Insurance cover as required by law (whichever may apply)

<b>DETAILS OF CONTRACTOR'S WORK COVER INSURANCE</b>	<b>INSURER:</b>	
	<b>POLICY NUMBER:</b>	
	<b>SUM INSURED:</b>	
	<b>CURRENT TO:</b>	
<b>DETAILS OF CONTRACTOR'S PUBLIC LIABILITY INSURANCE</b>	<b>INSURER:</b>	
	<b>POLICY NUMBER:</b>	
	<b>SUM INSURED:</b>	
	<b>CURRENT TO:</b>	
<b>DETAILS OF CONTRACTOR'S</b>	<b>INSURER:</b>	

<b>PRODUCT LIABILITY INSURANCE</b>	<b>POLICY NUMBER:</b>	
	<b>SUM INSURED:</b>	
	<b>CURRENT TO:</b>	
<b>COPIES OF YOUR CURRENT INSURANCE CERTIFICATE FOR ALL INSURANCES MUST BE ATTACHED.</b>		

## 10. REGISTRATION DETAILS

CONTRACTORS ARE TO COMPLETE BELOW TABLE, AFTER HAVING REGARD TO LEVELS OF REGISTRATIONS REQUIRED BY CONDITIONS OF CONTRACT AS STATED BELOW

<b>DETAILS OF CONTRACTOR'S ABN REGISTRATION</b>	<b>REGISTRATION No:</b>	
<b>DETAILS OF RELEVANT LICENSE</b>	<b>REGISTRATION No:</b>	
	<b>ISSUE DATE:</b>	
	<b>EXPIRY DATE:</b>	
<b>PLEASE ATTACH A COPY OF YOUR CURRENT REGISTRATION MENTIONED ABOVE.</b>		

***Persons conducting works under this contract shall hold the necessary nationally recognised competencies to conduct the required work and the necessary licensing to operate any plant or equipment. If the statutory requirements change during the period of this contract, no additional charge will be borne by Council.***

## 11. INDEMNITY

The successful Contractor must indemnify and keep indemnified the Council against:

- Any liability under the *Workers' Compensation and Rehabilitation Act 2003* as amended from time to time; and
- Any other law in force or which during the term of this Contract may come into force, under which any person is entitled to claim or sue for compensation or recover any damages from the Council.

## 12. COLLECTION OF PERSONAL INFORMATION

Banana Shire Council is collecting your personal information in accordance with the *Local Government Act 2009* (the Act) and the *Local Government Regulation 2012* (the Regulation) for the purpose of evaluating your submission and administering any subsequent contract. Generally, we will not disclose your personal information outside of Council unless we are required by law or you have given your consent. However, in order to perform the above functions, we may need to disclose your personal information to your referees and ATO. Further, under the Regulation Council is required to publish the relevant details of any contract worth \$200,000 or more on its website. By completing and signing this form and returning it to Council, we will consider that you have given us your consent to manage your personal information in the manner described in Council's [Privacy Statement](#), [Privacy Procedure](#) and this collection notice.



### **13. NOTICE OF VARIATIONS**

Where the contractor is given a direction to vary the work under the contract which is not expressly identified in writing as a variation, the contractor must promptly, and where practicable before complying with the direction, give the Project Manager a written notice which identifies the direction and states that the contractor considers that the direction involves a variation. The variation should be noted on the Invoice and be itemised per variation.

### **14. WORK HEALTH & SAFETY FOR CONTRACTORS**

#### **WORK HEALTH & SAFETY SIGN OFF FOR CONTRACTORS**

Banana Shire Council is committed achieving high standards of WHS, where the safety of our employees, volunteers, contractors and the public is placed as our first priority.

Banana Shire Council requires that all contractors understand their health and safety (WHS) requirements prior to performing work for Council. Enclosed is a copy of the Workplace Health and Safety Information Package for Contractors.

It is essential that all contractors work in accordance with the obligations stated in the Work Health and Safety Act (2011) and all subordinate WHS legislation.



## BANANA SHIRE COUNCIL

### Policy

TITLE	<b>WORK HEALTH AND SAFETY POLICY STATEMENT</b>
POLICY NUMBER	<b>08</b>
FUNCTION / ACTIVITY (for Policy Register Purposes)	<b>WORK HEALTH AND SAFETY</b>
RESPONSIBLE DEPARTMENT	<b>EXECUTIVE SERVICES</b>
LEGISLATION	<b>Work Health and Safety Act 2011 Work Health and Safety Regulation 2011</b>
ADOPTED	<b>14 December 2007 Ordinary Meeting - Minute 32241</b>
REVIEWED/AMENDED	<b>EMT Meeting - 2 June 2008 EMT Meeting - 9 July 2012 Control of Policy transferred by Council to CEO as an Operational Policy - 12 December 2012 - Minute OM002173 Policy control reverted back to Council and adopted 27/08/2014 Ordinary Meeting - Minute No. OM002852 9/12/15 Ordinary Meeting – Minute No. OM003297 26/07/17 Ordinary Meeting – Minute No. OM003835 27/06/18 Ordinary Meeting – Minute No. OM004117</b>
NEXT REVIEW DUE	<b>June 2022</b>

#### SCOPE

This policy applies to all employees of the Banana Shire Council and includes contractors, volunteers, work experience students, trainees and visitors.

#### OBJECTIVE

The objective of this policy is to outline Council's responsibility, accountability and participation in Work Health and Safety.

#### POLICY

##### MISSION STATEMENT

At Banana Shire Council **'we are committed to promoting and striving for continuous growth and improvement in all that we do, for the benefit and growth of the whole of the Shire'**.

##### WORK HEALTH & SAFETY COMMITMENT

Banana Shire Council is committed to the continual improvement of its Work Health and Safety performance in all of our operations and implement a Safety Management System aligned with the requirements of Safeplan to support this improvement approach. We will strive to deliver on these commitments by -

- Create and maintain a safe and healthy working environment and provide an injury and illness free workplace.



- Develop proactive health and safety strategies and adopt a risk management approach to operations in order to eliminate work related injury and illness.
- Communicate openly and honestly with our employees, contractors, suppliers, other business partners and interested third parties to encourage a health and safety culture that reflects the intent of this policy.
- Set measurable objectives and targets and monitor progress against these regularly reviewing our health and safety performance, considering the effectiveness of work health and safety activities and ensuring our health and safety targets are being met to achieve results of which we can all be proud.
- Fully implement Banana Shire Council's Work Safety and Health Management System and compliance to all relevant legislation. This requires the allocation of appropriate resources and the provision of training, education, consultation and auditing to ensure compliance.
- Ensuring the Executive Management Team and employees, contractors, volunteers and visitors carry out their health and safety responsibilities.
- Periodically review this policy to ensure it remains relevant and appropriate to Banana Shire Council.

The Executive Management Team takes overall responsibility for the governance of Work Health and Safety at Banana Shire Council.

The adoption and promotion of this policy is mandatory for all employees of Banana Shire Council and for contractors and suppliers acting on our behalf.

## PROCEDURE

As approved and issued by the Chief Executive Officer and subject to future revision, amendment and issue under the authority of the Chief Executive Officer.

## CERTIFICATION

  
.....  
**CHIEF EXECUTIVE OFFICER**  
**BANANA SHIRE COUNCIL**

  
.....  
**DATE**

## GENERAL HEALTH & SAFETY RULES FOR CONTRACTORS

Banana Shire Council welcomes you to our Workplace. Council recognises its responsibility and commitment to ensure health and safety of all workers including contractors. Therefore it is important for you to be aware of your responsibilities under the Work Health and Safety Legislation 2011

The following conditions will apply:

- **Inductions - All workers** who attend a worksite are required to complete a formal Council Contractors induction and a Site Specific Induction prior to mobilisation to site. Inductions will be arranged at convenient times for the contractor before commencement and must be **renewed every 12 months**. If the Contractor/Service Provider's employee or subcontractor fails to maintain the required inductions, BSC reserves the right to refuse or remove the subject parties from BSC sites.
- All workers must maintain current and accurate information relating to licences, tickets and qualifications at all times
- All contractors **must** read the contents of this document before commencing work on Council worksites.
- All contractors **must** comply with the wearing of Personal Protective Equipment/ Clothing whilst working in council work locations.
- **Smoking** is prohibited in Council offices, workshops, buildings, vehicles and on Worksites within 4 metres of crib huts, facilities and other persons.
- **Drugs and Alcohol** are not permitted on any Council worksites or vehicles and in the operation of plant and vehicles. If you require any medication that may impact on your ability to safely operate a vehicle / or machinery you must furnish a letter from your Medical Practitioner advising of the type, quantity and effects of the medication to the site supervisor and Council's Contractor Supervisor.

**Failure to adhere to Work Health and Safety Legislation by any contractor will result in the contractor being required to rectify their actions, refusal to do so will result in contractor being asked to stop work and leave the BSC work area.**

- Hire machinery or machinery owned by contractors must comply with all relevant standards and maintenance records must be available on / with the machine and shown as requested.
- Contractors who operate machinery must be able to show proof of training, licences and certificates of competency prior to the start of work, these must be available for inspection by site supervisor or Councils WHS staff on request.
- Incidents and near misses including damage to Telstra, Ergon Energy or gas services must be reported to the Supervisor immediately and a written report completed and given to Council's Contractor Supervisor or Safety Advisors as soon as possible.
- Hazards must be assessed immediately and if they are not able to be adequately controlled reported to the worksite supervisor.
- Electrical equipment that is to be used on council sites must be tested and tagged to comply with Electrical Safety Act and Regulations 2013.

First Aid Kits are to be provided at each worksite.

It is the Contractor's obligation to ensure that all of their staff who performs construction work for Banana Shire Council has a General Construction Induction Card (White/Blue Card) when entering any construction worksites. Any staff members who will be performing construction work must be required to present their card for verification on each worksite as part of the sign in process for the construction safety induction. Staff who cannot provide evidence of the White/Blue Card are not to be permitted to perform any construction activities whilst on the worksite.

## CERTIFICATION

The information provided in this checklist is an accurate summary of the company's WH&S systems.

By signing this (Quotation) form the Proposed Contractor agrees to abide by all Councils Policies and Procedures in relation to this quotation response and the process of contractor engagement.

I/We accept that the Council reserves the right to negotiate with Proposed Contractors in relation to secure the best outcome for Council.

I/We agree to keep any Council negotiations in relation to the proposed contract confidential for all time.

COMPANY  
NAME: \_\_\_\_\_

SIGNATURE: \_\_\_\_\_ NAME: \_\_\_\_\_

POSITION: \_\_\_\_\_ DATE: \_\_\_\_\_

CONTACT NAME: \_\_\_\_\_ CONTACT NUMBER: \_\_\_\_\_



Attachment 1

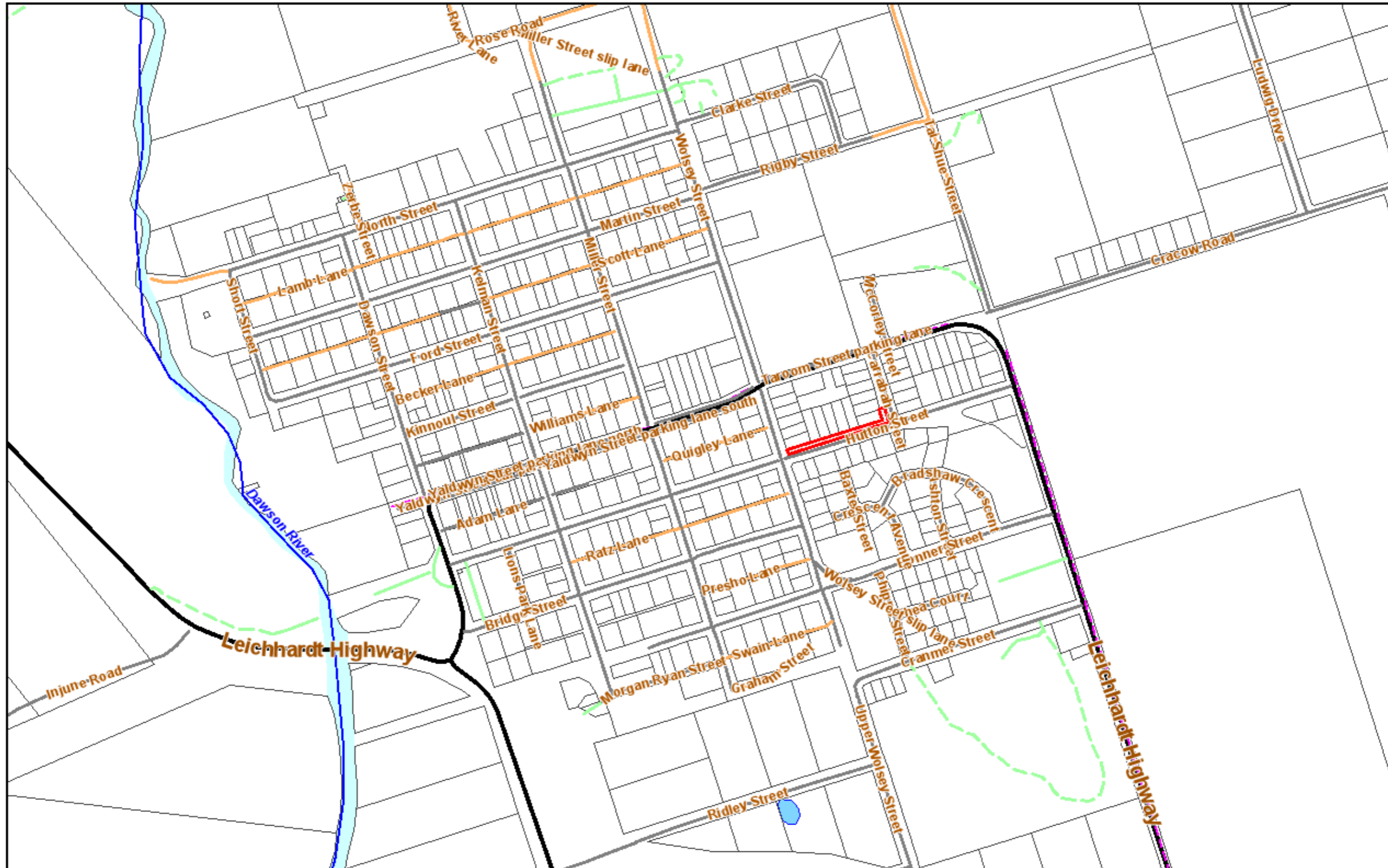

This publication has been produced by Banana Shire Council and is based on cadastral data provided by and used with the permission of the Department of Natural Resources and Mines (2022).

© Banana Shire Council and The State of Queensland (Department of Natural Resources and Mines) (2022).

Banana Shire Council and The Department of Natural Resources and Mines give no warranty in relation to the data (including accuracy, reliability, completeness or suitability) and accept no liability (including without limitation liability in negligence) for any loss, damage or costs (including consequential damage) relating to any use of the data.

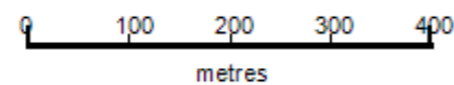

Scale 1 : 9,590 (A4 Original Size)  
Transverse Mercator projection, GDA94, MGA Zone 56



**SK0938 - Scope of Works**

Attachment 2

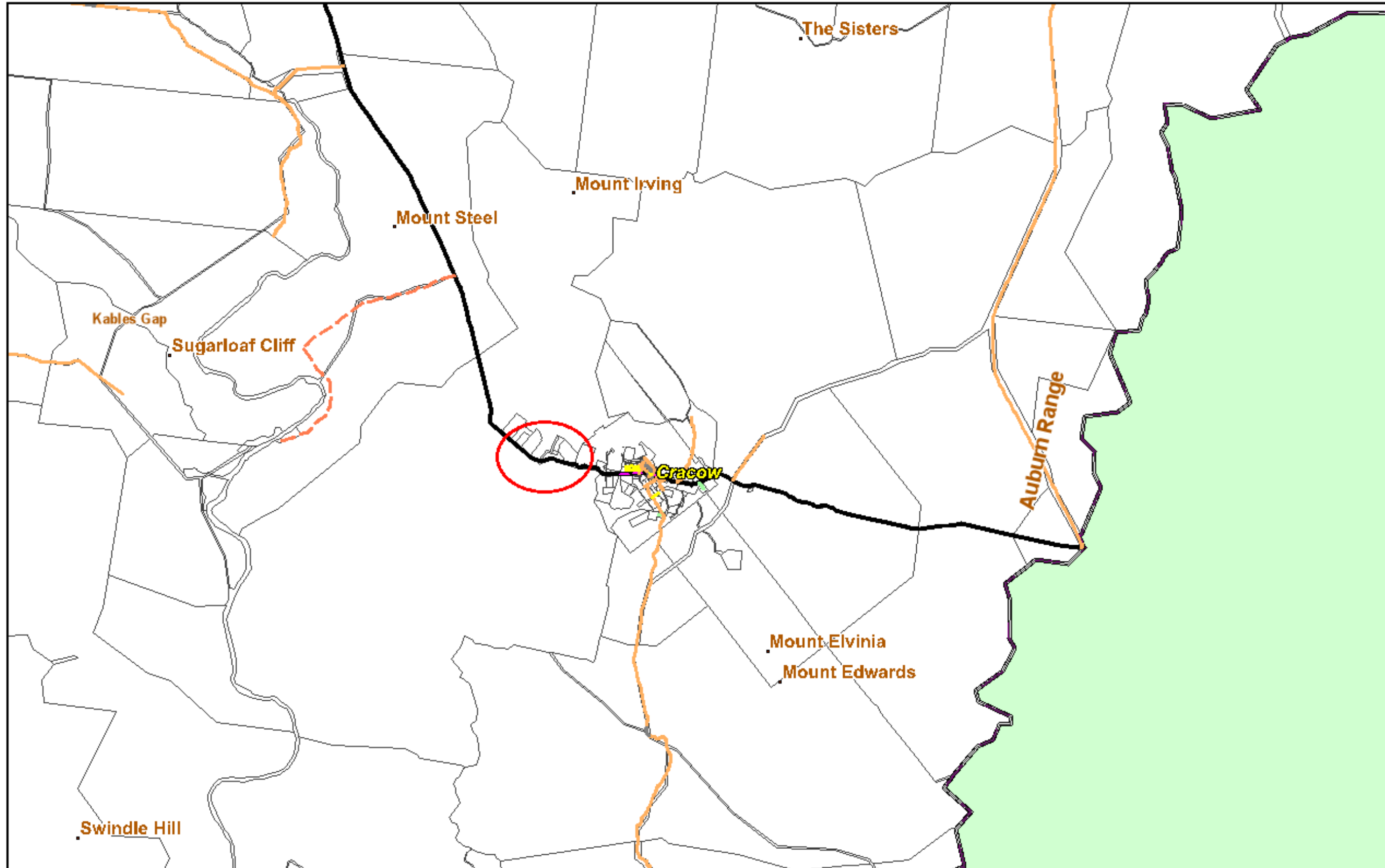

This publication has been produced by Banana Shire Council and is based on cadastral data provided by and used with the permission of the Department of Natural Resources and Mines (2022).

© Banana Shire Council and The State of Queensland (Department of Natural Resources and Mines) (2022).

Banana Shire Council and The Department of Natural Resources and Mines give no warranty in relation to the data (including accuracy, reliability, completeness or suitability) and accept no liability (including without limitation, liability in negligence) for any loss, damage or costs (including consequential damage) relating to any use of the data.



Scale 1 : 158,207 (A4 Original Size)  
Transverse Mercator projection, GDA94, MGA Zone 56



**SK12272 - Scope of Works**



Attachment 3

NO WORK IS SO  
IMPORTANT THAT  
IT CANNOT BE  
DONE SAFELY

HUTTON STREET K&C  
K&C REPLACEMENT  
IDP ID NO. 19/20 0161-0938-9005

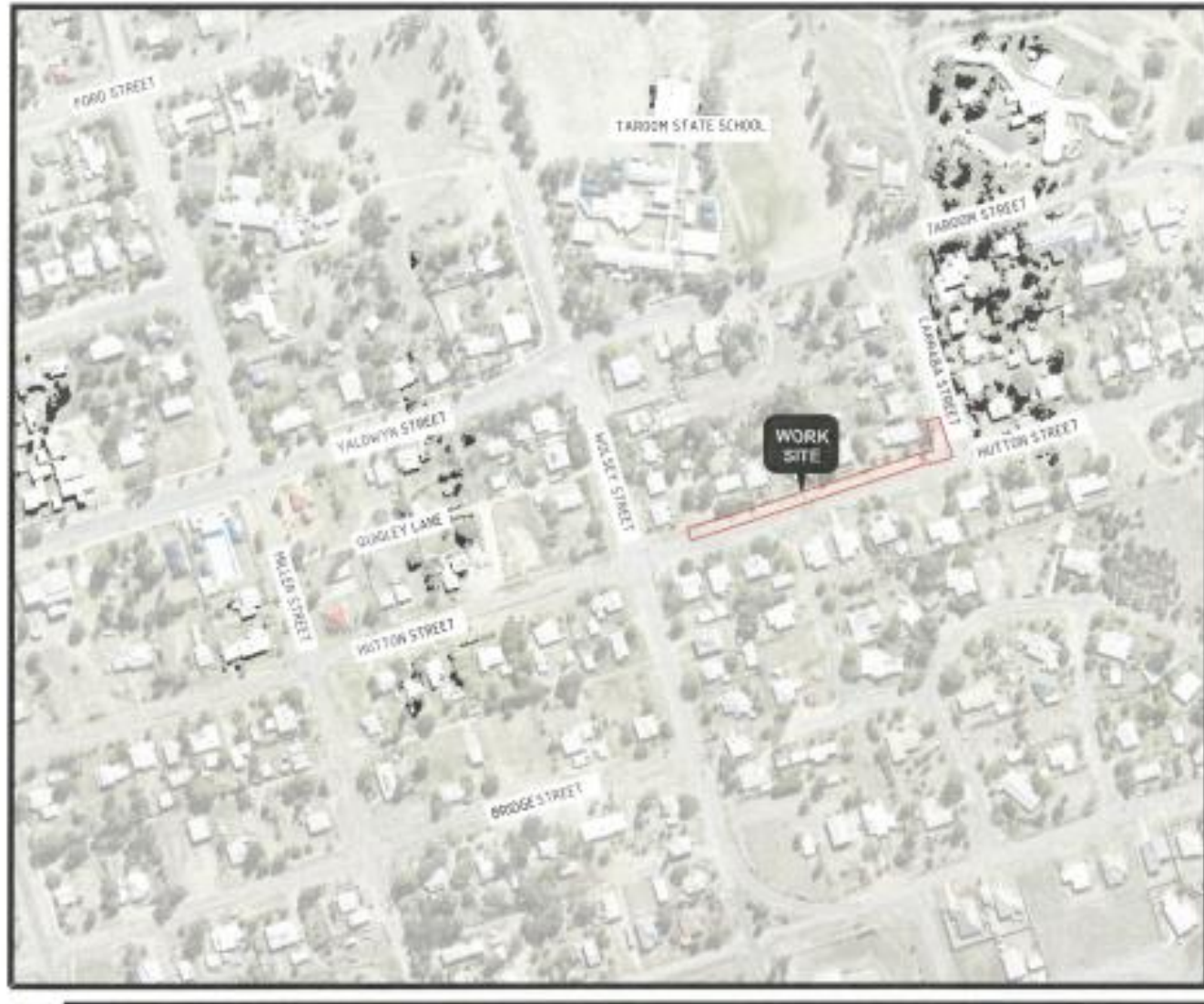

DRAWING INDEX		
SHEET NO:	DESCRIPTION	DRAWING NO:
1	DRAWING INDEX AND LOCALITY PLAN	0161-0938-9005-001
2	EXISTIN FEATURES PLAN	0161-0938-9005-002
3	PROPOSED WORK PLAN	0161-0938-9005-003
4	TYPICAL SECTIONS	0161-0938-9005-004
5	LONGITUDINAL SECTION, SETOUT AND SURVEY CONTROL	0161-0938-9005-005
6	CROSS SECTION FROM CH 253 TO CH 330	0161-0938-9005-006
7	CROSS SECTION FROM CH 340 TO CH 419	0161-0938-9005-007
8	CROSS SECTION FROM CH 420 TO CH 452	0161-0938-9005-008
9	DRIVEWAYS LONGITUDINAL SECTION	0161-0938-9005-009
10	CMDG-D-020	0161-0938-9005-010
11	CMDG-R-06A	0161-0938-9005-011

**FOR CONSTRUCTION**  
08/04/2022

<table border="1"> <tr> <td>1</td> <td>FOR CONSTRUCTION</td> <td>08/04/2022</td> </tr> <tr> <td>2</td> <td>FOR REVIEW</td> <td>05/04/2022</td> </tr> <tr> <td>3</td> <td>PRELIMINARY</td> <td>11/03/2022</td> </tr> <tr> <td>NO.</td> <td>REVISION</td> <td>DATE</td> </tr> </table>		1	FOR CONSTRUCTION	08/04/2022	2	FOR REVIEW	05/04/2022	3	PRELIMINARY	11/03/2022	NO.	REVISION	DATE	<p>S. MAGAROTI DESIGN A. REIT</p> <p>I. JOHNSON NEW BROWN</p> <p>12/4/22</p>	 	<p>HUTTON STREET K&amp;C DRAWING INDEX AND LOCALITY PLAN</p> <p>SCALE: NOT TO SCALE</p> <p>DWG. NO: 0161-0938-9005-001</p> <p>SHEET: 1 OF 11</p> <p>ISSUE: 1</p>
1	FOR CONSTRUCTION	08/04/2022														
2	FOR REVIEW	05/04/2022														
3	PRELIMINARY	11/03/2022														
NO.	REVISION	DATE														







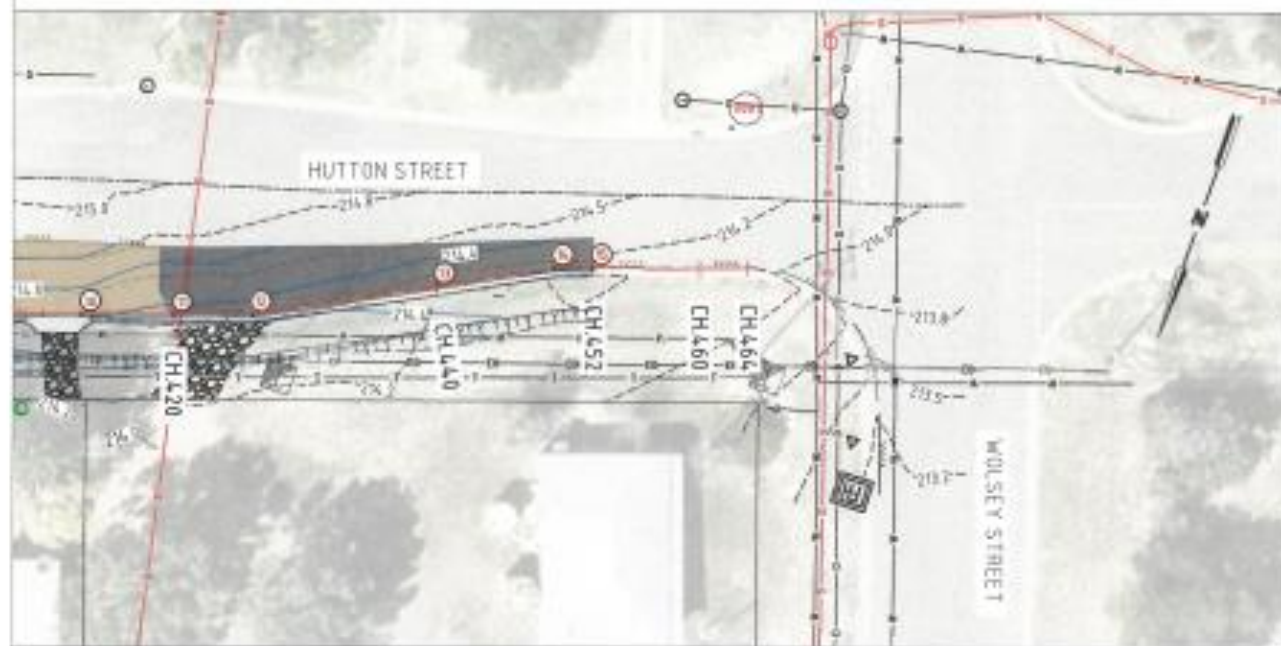
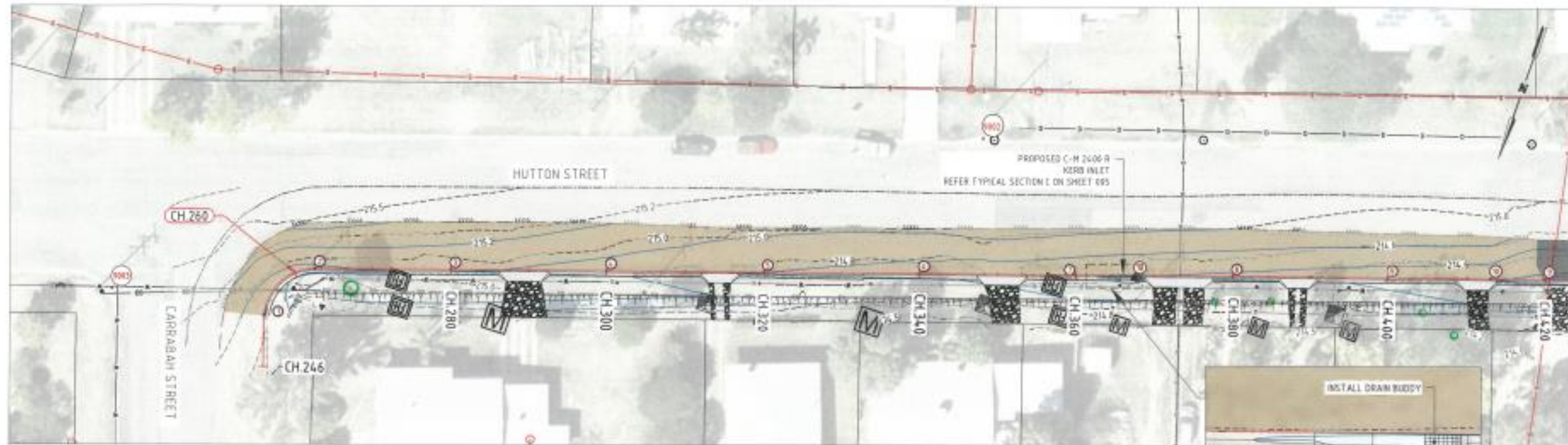

- EXISTING CENTERLINE
- EXISTING EDCB
- EXISTING EDGE OF BITUMEN
- PROPOSED LIP OF CHANNEL ALIGNMENT
- PROPOSED LAY BACK KERB CHANNEL
- PROPOSED TOE OF EMBANKMENT
- PROPOSED TOP OF EMBANKMENT
- DESIGN SURFACE CONTOUR
- EXISTING SURFACE CONTOUR
- EXISTING OVERHEAD ELECTRIC AND POLE
- EXISTING STORM WATER PIPE (APPROXIMATE LOCATION)
- EXISTING WATER MAIN (APPROXIMATE LOCATION)
- EXISTING TELSTRA LINE (REFER D810 FOR DETAIL)
- EXISTING WATER VALVE
- EXISTING SEWER MAIN AND MANHOLE (APPROXIMATE LOCATION)
- PROPOSED GRAVEL DRIVEWAY
- PROPOSED GRAVEL RE-SHEET
- PROPOSED DRIVEWAY RAMP
- PROPOSED PAVEMENT RECONSTRUCTION AND SEAL
- EXISTING TELSTRA PIT
- FIRE HYDRANT
- EXISTING STORM WATER PIT
- SURVEY CONTROL
- EXISTING WATER METER

**SCOPE OF WORKS**

- SITE ESTABLISHMENT
- PROVISION FOR TRAFFIC
- DEMOLITION AND DISPOSAL OF EXISTING KERB AND CHANNEL
- REMOVAL AND DEMOLITION OF EXISTING CONCRETE RAMPS ON PROPERTY ACCESSES
- REMOVAL OF EXISTING INLET AND GRATE
- INSTALLATION OF PRECAST KERB INLET TYPE C/M/R
- RECONSTRUCTION OF KERB AND CHANNEL
- GRAVEL RE-SHEET
- RECONSTRUCTION OF GRAVEL DRIVEWAY
- SAW CUTTING EXISTING ROAD
- PAVEMENT RECONSTRUCTION

**NOTES**

- ALL TELSTRA PIT AND FIRE HYDRANTS SHALL BE RAISED TO MATCH THE DESIGN SURFACE
- REFER 004 FOR TYPICAL SECTIONS
- REFER 005 SETOUT DETAILS
- REFER CHDG-D-829 FOR KERB INLET INSTALLATION
- REFER CHDG-R-800A FOR STANDARD KERB AND CHANNEL PROFILE

**DRIVEWAYS CONSTRUCTION NOTE**

- REFER SHEET 005 FOR DRIVEWAY RAMP TYPICAL SECTION
- REFER SHEET 009 FOR DRIVEWAY LOW SECTION
- REMOVE ALL EXISTING DRIVEWAY RAMPS

SURVEY CONTROL			
POINT No.	EASTING	NORTHING	LEVEL
9001	118804.824	7163184.517	214.602
9002	118810.762	7160216.294	215.058
9003	118813.513	7168269.230	215.241

**FOR CONSTRUCTION**  
08/04/2022

NO.	REVISION	DATE
1	FOR CONSTRUCTION	08/04/2022
2	FOR REVIEW	05/04/2022
3	PRELIMINARY	14/03/2022

ALL UNDERGROUND SERVICES SHALL BE IDENTIFIED BY POT HOUND BEFORE COMMENCING ANY EARTH WORKS

GENERAL NOTES:

S. NAGARKOTI  
I. JOHNSON  
DESIGN: A. HEIT  
REV: G. OWEN  
CHKD: M. B. 15/02  
12/4/21



HUTTON STREET K&C PROPOSED WORKS PLAN	
SCALE	DWG NO.
1:500	8761-0938-0005-003
DESCRIPTION	SHEET 3 OF 11
	ISSUE 1





**KERB LIP SET OUT**

POINT No.	EASTING	NORTHING	LEVEL	KERB LIP
1	178993.988	7160266.443	214.806	KERB LIP
2	178989.576	7160258.775	214.954	KERB LIP
3	178984.192	7160251.504	215.030	KERB LIP
4	178954.854	7160247.409	214.919	KERB LIP
5	178935.005	7160241.314	214.894	KERB LIP
6	178915.956	7160235.219	214.721	KERB LIP
7	178896.988	7160229.124	214.641	KERB LIP
8	178877.859	7160223.028	214.561	KERB LIP
9	178858.811	7160216.933	214.481	KERB LIP
10	178846.426	7160212.971	214.429	KERB LIP
11	178839.756	7160210.857	214.352	KERB LIP
12	178834.155	7160209.082	214.328	KERB LIP
13	178821.524	7160202.761	214.263	KERB LIP
14	178813.418	7160198.704	214.216	KERB LIP
15	178806.632	7160197.778	214.201	KERB LIP
16	178809.712	7160226.827	214.618	GRATE BOTTOM CENTRE

NO WORK IS SO IMPORTANT THAT IT CANNOT BE DONE SAFELY

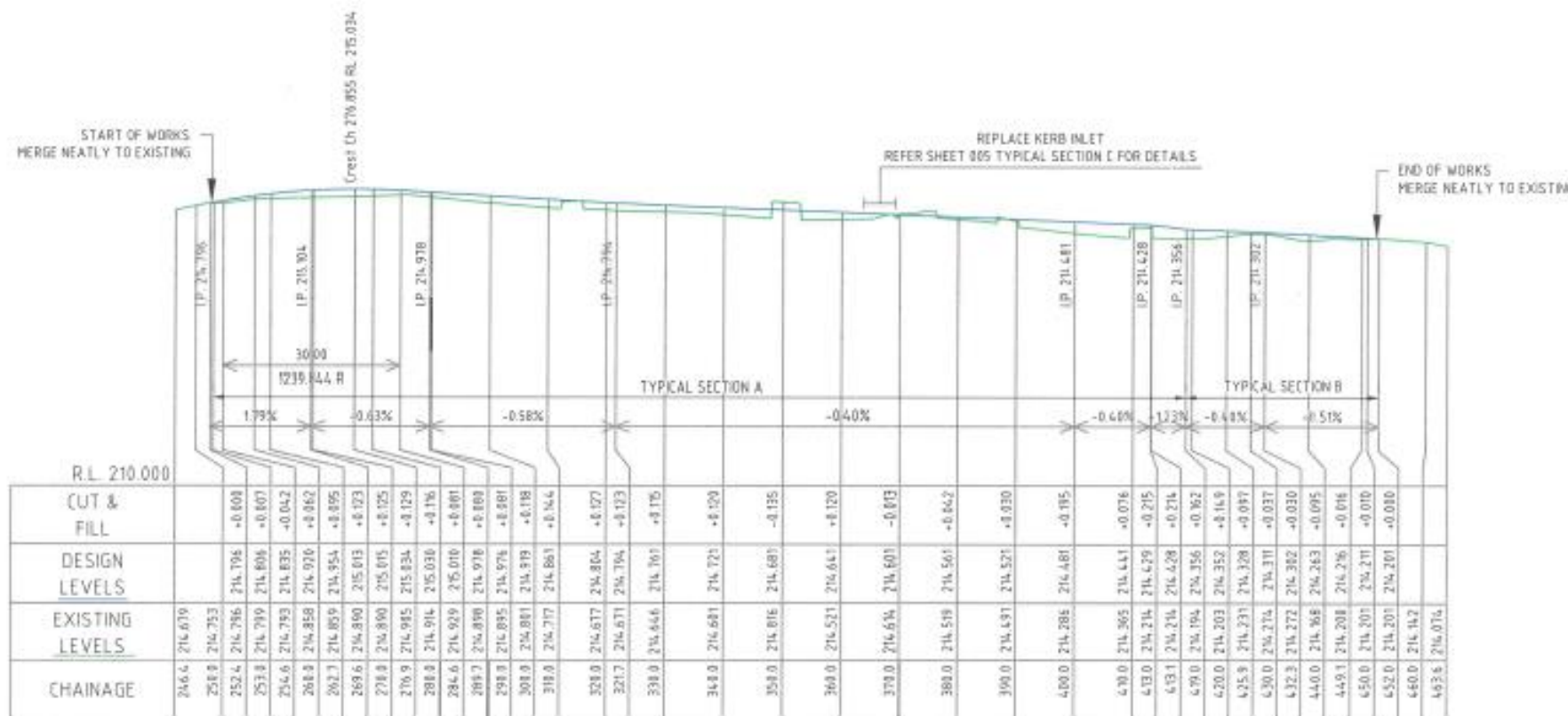

LONGITUDINAL SECTION FROM CH.246 & 38 TO CH.463.640  
1 in 1000 HORIZONTAL 1 in 100 VERTICAL

**FOR CONSTRUCTION**  
08/04/2022

NO.	REVISION	DATE	GENERAL NOTES
1	FOR CONSTRUCTION	08/04/2022	
B	FOR REVIEW	05/04/2022	
A	PRELIMINARY	14/03/2022	

S. NAGARKOTI  
DESIGN  
A. HOY  
CHKD  
2/4/22

I. JOHNSON  
HW  
G. PROBY  
CHKD  
8/10/22





www.1100.com.au

**HUTTON STREET K&C**  
LONGITUDINAL SECTION, SETOUT TABLE AND SURVEY CONTROL

SCALE:  1:1000

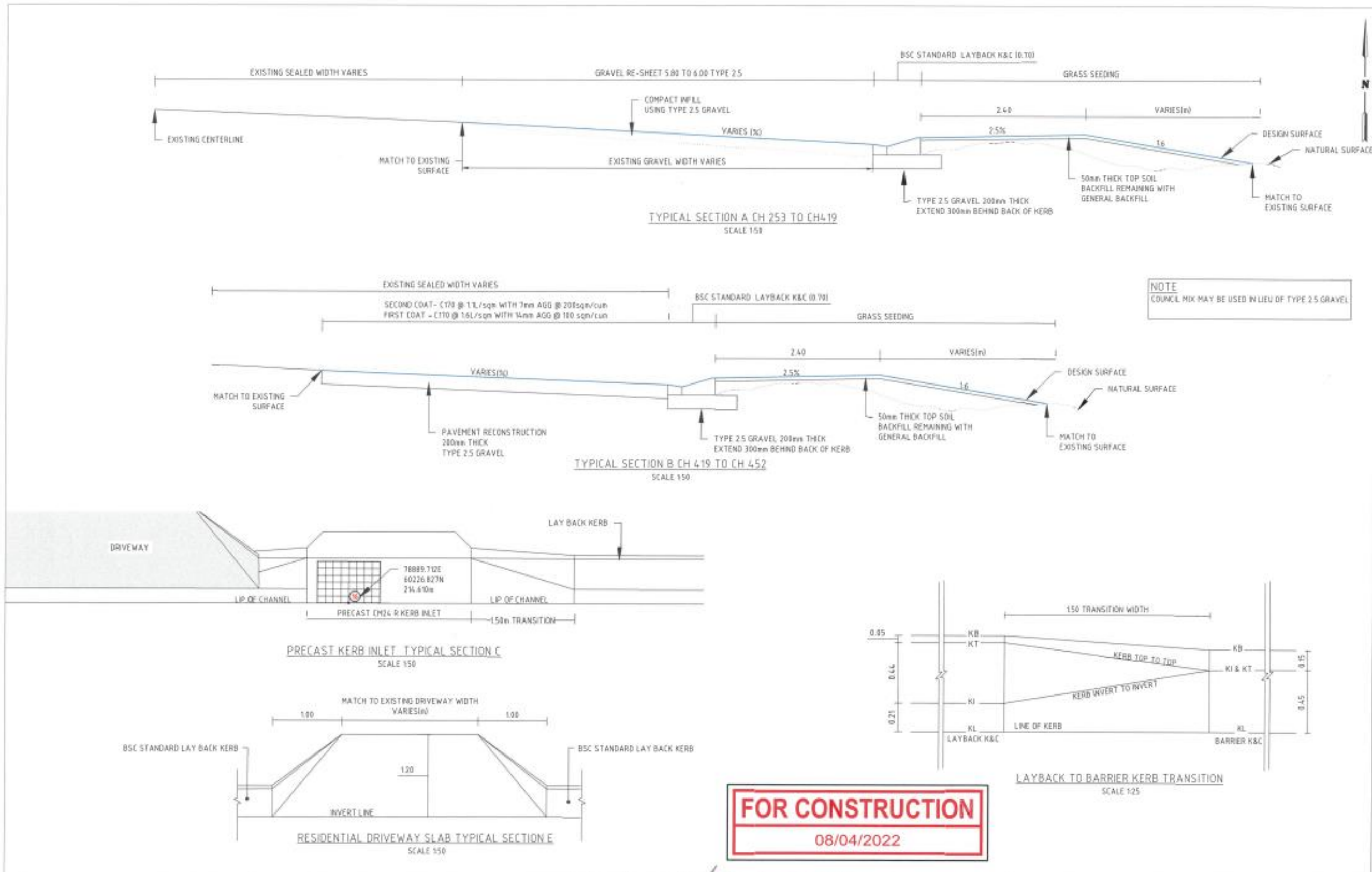
DWS NO: 0161-0938-9005-004  
SHEET: 4 OF 11  
ISSUE: 1



NO.	REVISION	DATE	GENERAL NOTES
1	FOR CONSTRUCTION	08/04/2022	
B	FOR REVIEW	05/04/2022	
A	PRELIMINARY	16/03/2022	

DESIGN: A. HEIT  
DRAWN: G. JOHNSON  
CHECKED: R. PEO  
DATE: 12/4/22

S. NAGARKOTI  
I. JOHNSON



HUTTON STREET K&C TYPICAL SECTION		SCALE: AS SHOWN	DWG NO: 0161-8938-9005-005	SHEET: 5 OF 11	ISSUE: 1
--------------------------------------	--	-----------------	----------------------------	----------------	----------







FOR CONSTRUCTION  
08/04/2022

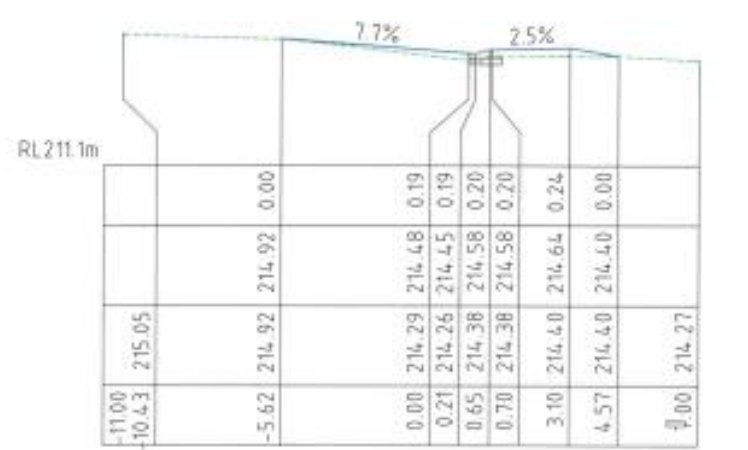
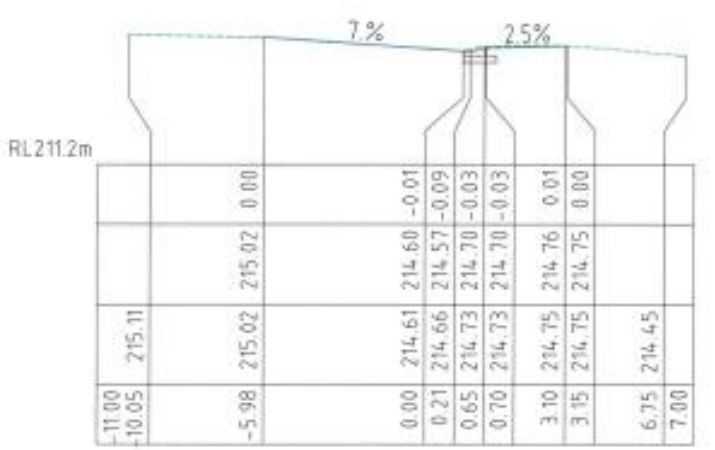
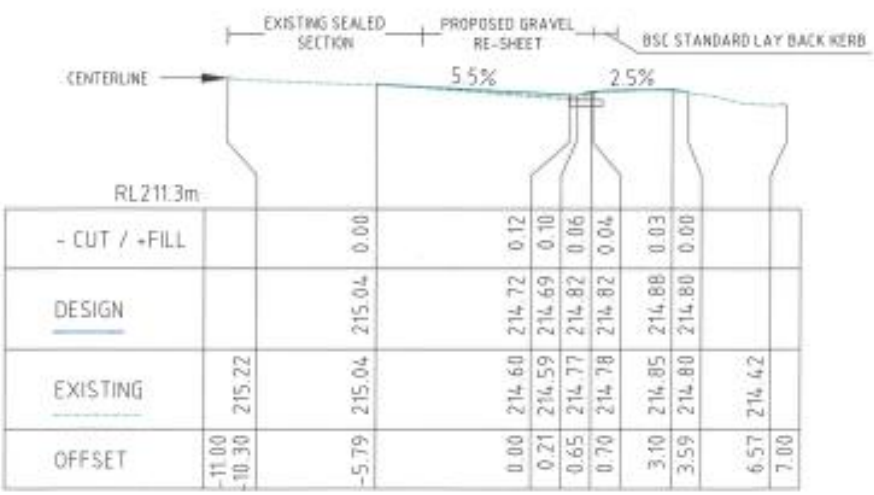
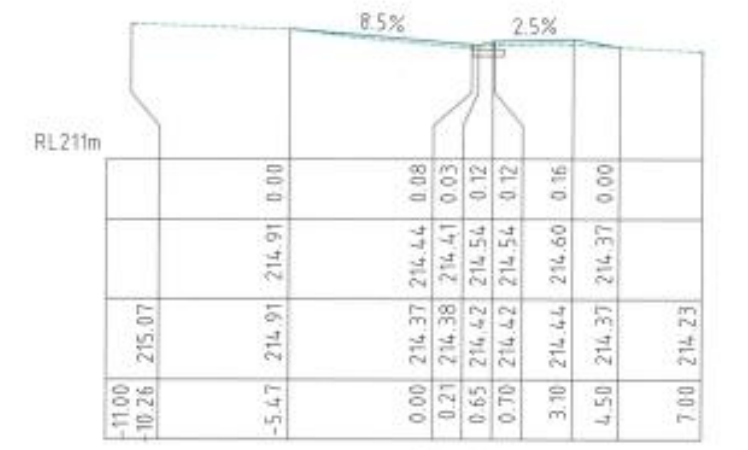
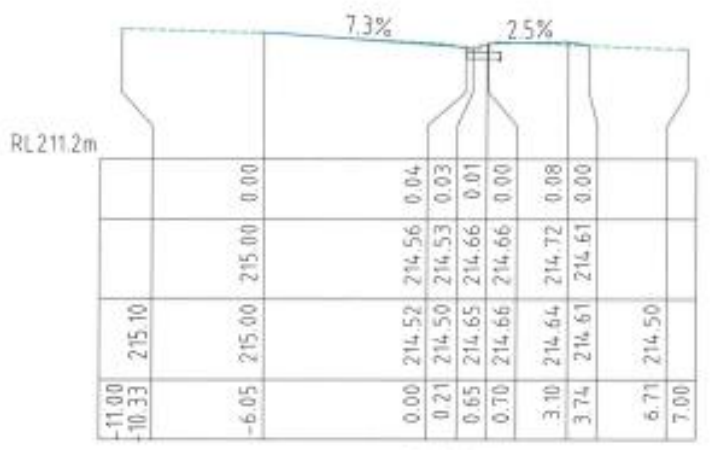
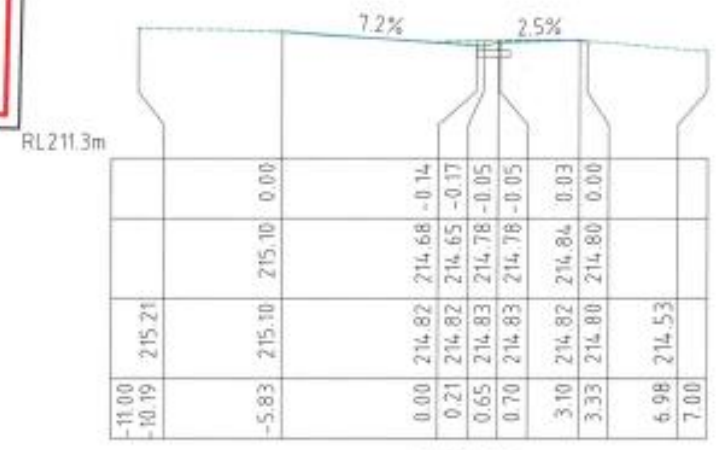
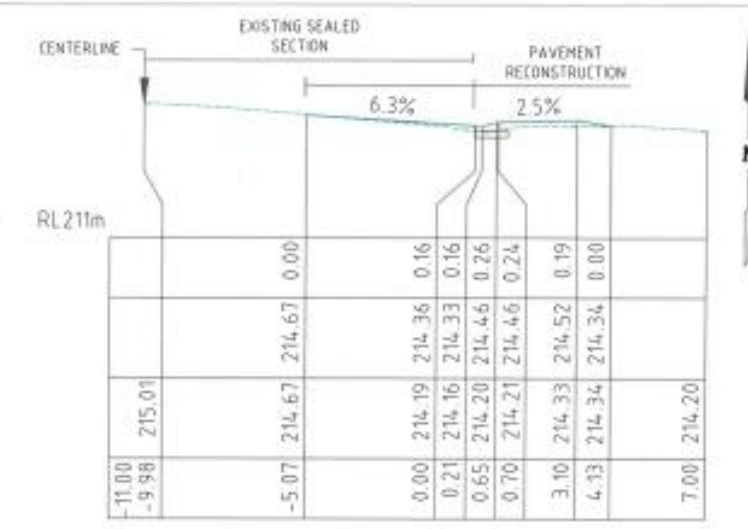
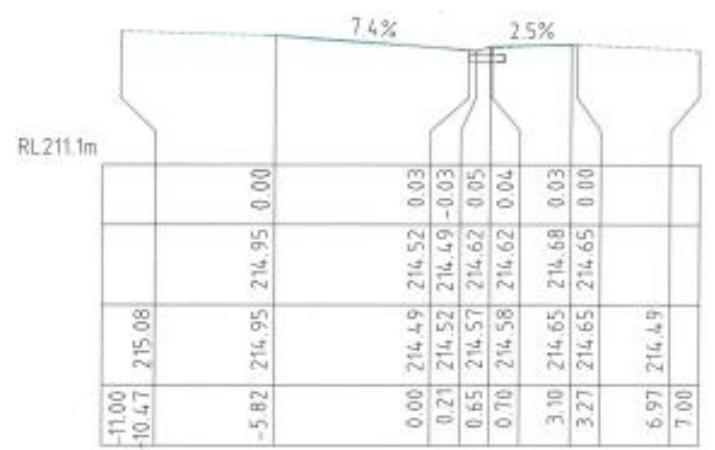
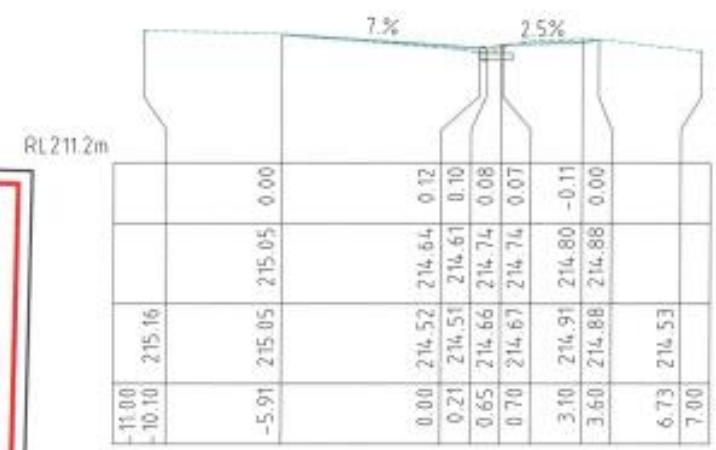

NO	REVISION	DATE	GENERAL NOTES
1	FOR CONSTRUCTION	08/04/2022	
B	FOR REVIEW	05/04/2022	
A	PRELIMINARY	14/03/2022	

GENERAL NOTES:

S. NAGARKOTI  
DESIGN  
A. HEIT  
CHKD  
12/4/22





www.1100.com.au

HUTTON STREET K&C  
CROSS SECTION FROM CH340 TO CH419

SCALE 1:200  
DESCRIPTION

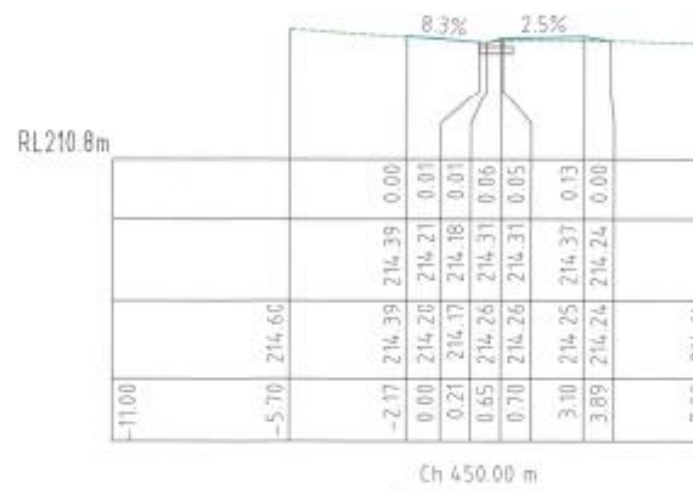
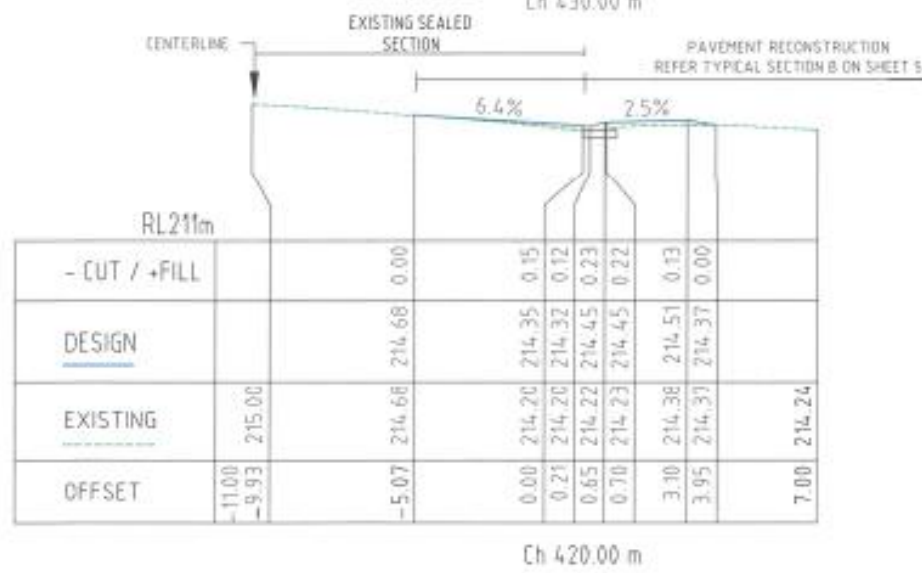
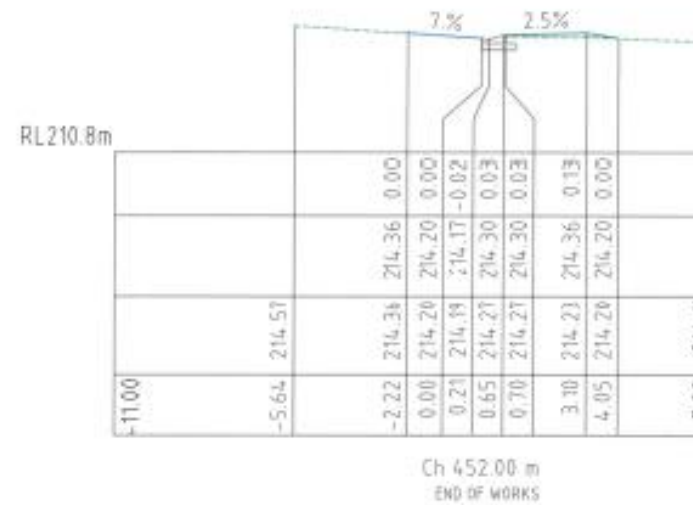
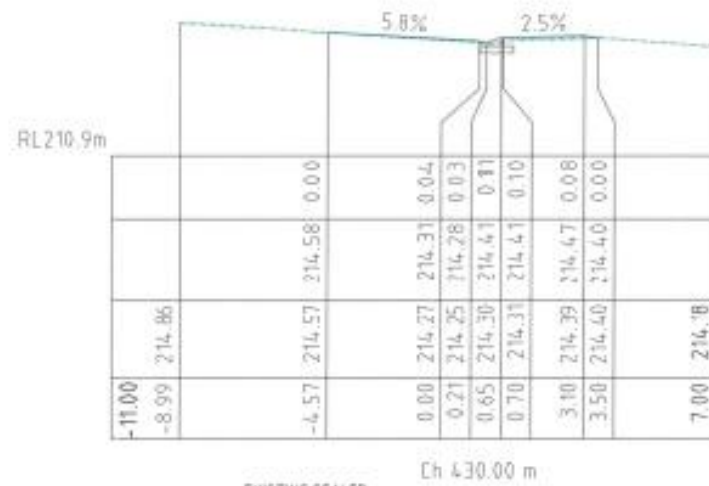
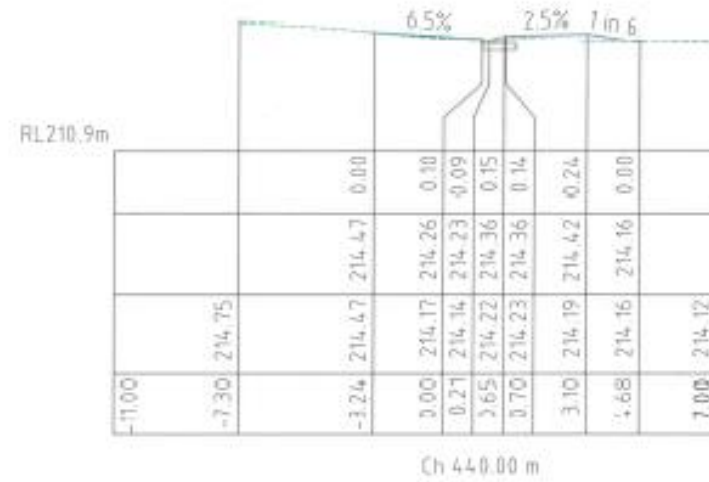
DWG NO. 0167-0938-9005-007  
SHEET 7 OF 11  
ISSUE 1



**FOR CONSTRUCTION**  
08/04/2022

NO.	REVISION	DATE
1	FOR CONSTRUCTION	08/04/2022
2	FOR REVIEW	05/04/2022
3	PRELIMINARY	14/03/2022

GENERAL NOTES:

S. NAGARKOTI  
I. JOHNSON  
DESIGN  
A. HEIT  
G. BROWN  
12/4/22



www.1100.com.au

HUTTON STREET K&C  
CROSS SECTION FROM CH420 TO CH452

SCALE 0 1 2 3 4 1:200

DWG NO. 051-0018-0005-008

SHEET 8 OF 11

ISSUE 1



NO WORK IS SO  
IMPORTANT THAT  
IT CANNOT BE  
DONE SAFELY

**FOR CONSTRUCTION**  
08/04/2022

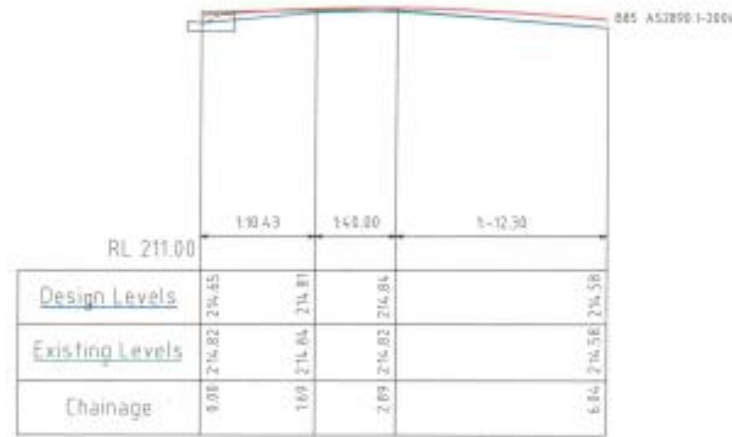

Road-KERB LIPChainage: 350Side of Road Right

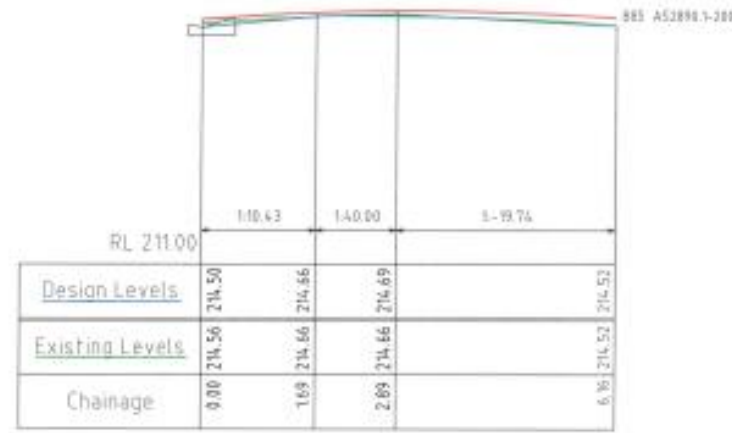

Road-KERB LIPChainage: 389Side of Road Right

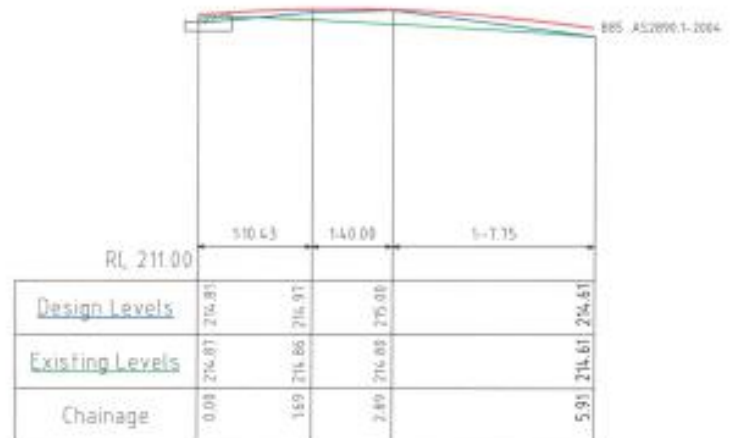

Road-KERB LIPChainage: 314Side of Road Right

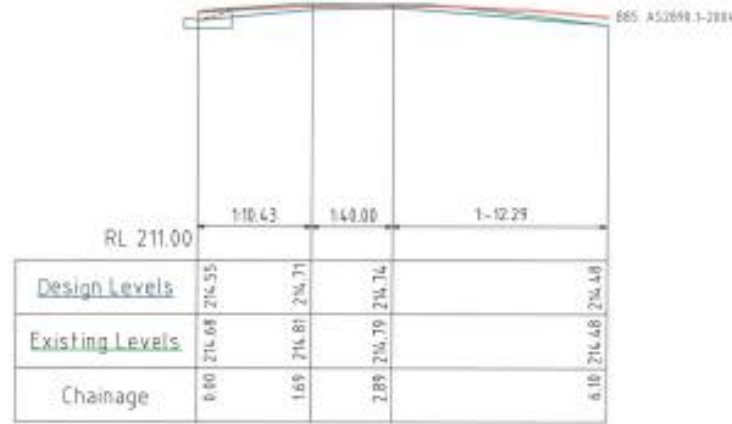

Road-KERB LIPChainage: 375Side of Road Right

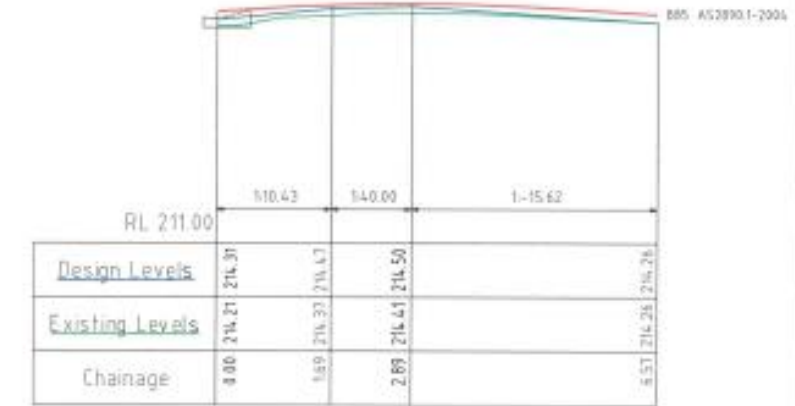

Road-KERB LIPChainage: 423Side of Road Right



Road-KERB LIPChainage: 289Side of Road Right

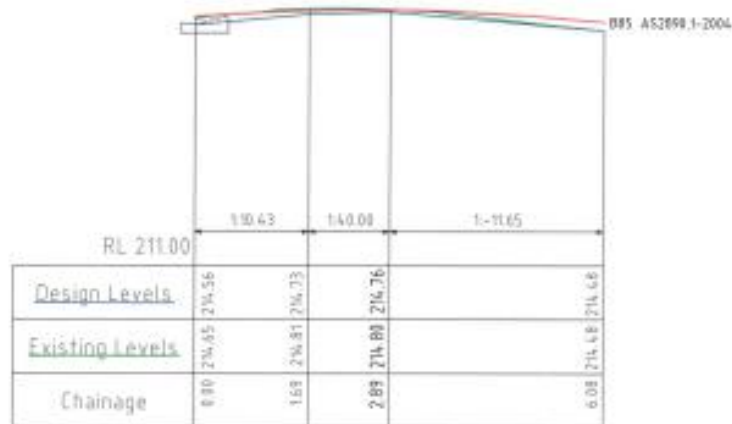

Road-KERB LIPChainage: 372Side of Road Right

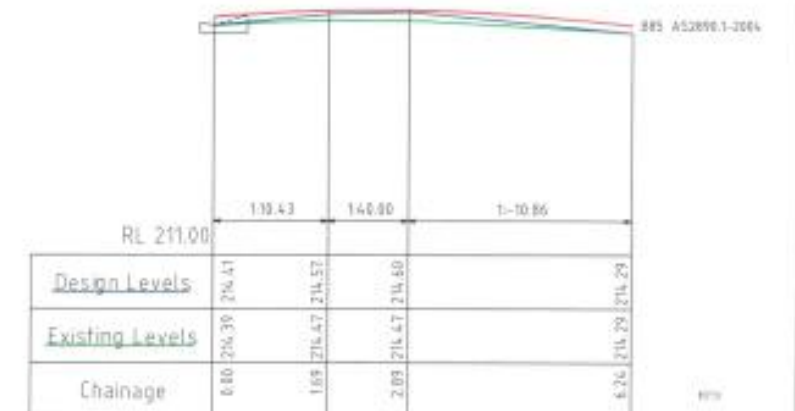

Road-KERB LIPChainage: 411Side of Road Right

NO	REVISION	DATE
1	FOR CONSTRUCTION	08/04/2022
2	FOR REVIEW	05/04/2022
3	PRELIMINARY	16/03/2022

GENERAL NOTES:

S. NAGARKOTI	I. JOHNSON
DESIGN	CHK
A. HEIT	G. BROWN
CHKD	RFCD



HUTTON STREET K&C  
DRIVEWAYS LONGITUDINAL SECTION

SCALE	DWG. NO.	SHEET	ISSUE
1:50	0761-0938-9005-009	9 OF 11	1

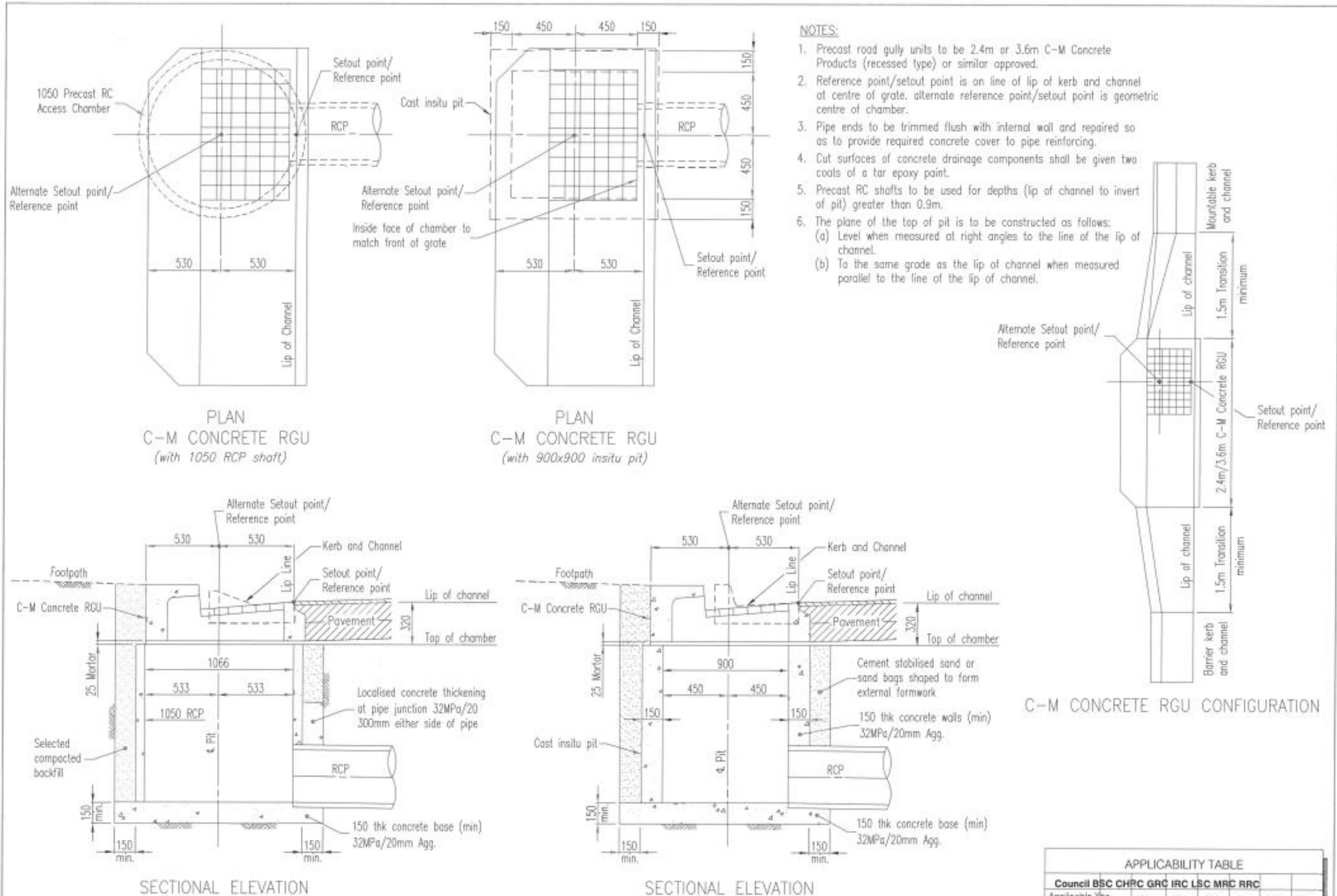

APPLICABILITY TABLE							
Council	BSC	CHRC	GRC	IRC	LSC	MRC	RRC
Applicable	Yes	Yes	Yes	Yes	Yes	Yes	Yes

REVISIONS	DATE
F IRC ADDED	12/2016
E CHRC AND LSC ADDED	09/2014
D MRC ADDED	04/2011
C REFERENCE TO LSC REMOVED	01/2011
B TRANSITION 1.5 MINIMUM	07/2010
A POST AMALGAMATION REVIEW	01/2010

**DISCLAIMER**  
The authors and sponsoring organizations shall have no liability or responsibility to the user or any other person or entity with respect to any liability, loss or damage caused or alleged to be caused, directly or indirectly, by the adoption and use of these Standard Drawings including, but not limited to, any interruption of service, loss of business or anticipatory profits, or consequential damages resulting from the use of these Standard Drawings. Persons must not rely on these Standard Drawings as the equivalent of, or a substitute for, project-specific design and assessment by an appropriately qualified professional.

**Capricorn Municipal Development Guidelines**  
Incorporating:  
Banana Shire Council (BSC) Livingstone Shire Council (LSC)  
Central Highlands Regional Council (CHRC) Maranoa Regional Council (MRC)  
Gladstone Regional Council (GRC) Rockhampton Regional Council (RRC)  
Isaac Regional Council (IRC)

PRECAST STORMWATER INLET  
INSTALLATION DETAILS

DRAINAGE  
STANDARD  
DRAWING  
CMDG-D-020  
REV: A | B | C | D | E | F



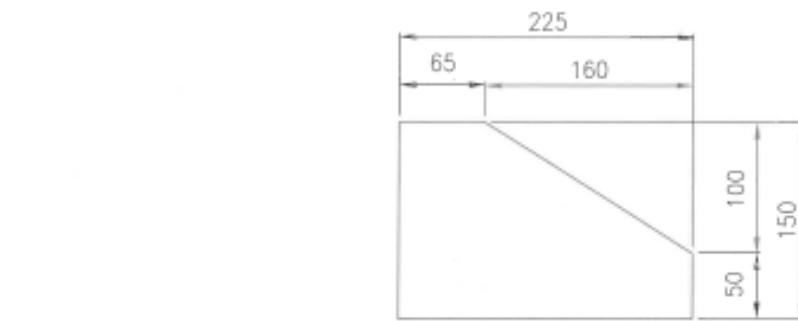

TYPE 4 - SEMI-MOUNTABLE KERB  
Scale - 1:5

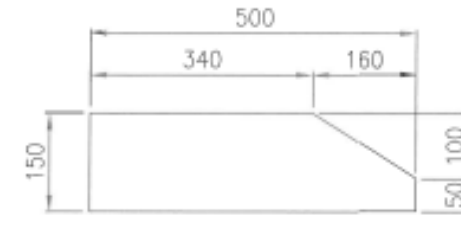

TYPE 5 - SEMI-MOUNTABLE KERB  
Scale - 1:10

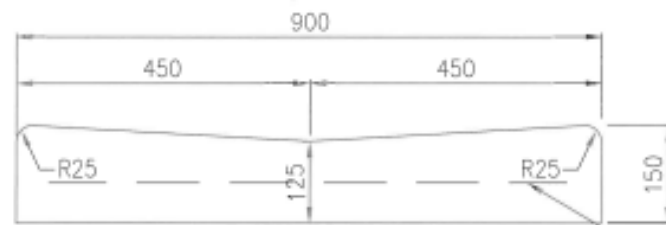

TYPE 7 - CONCRETE INVERT (900 WIDE)  
Scale - 1:10

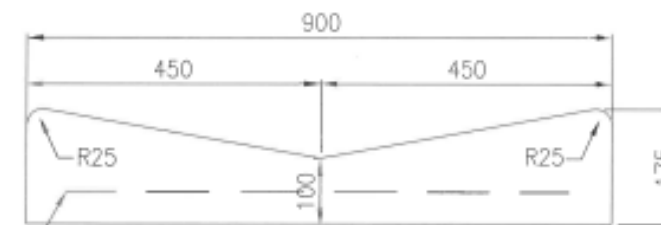

TYPE 8 - CONCRETE CHANNEL (900 WIDE)  
Scale - 1:10

SL62 Centrally placed, concrete strength 32 MPa

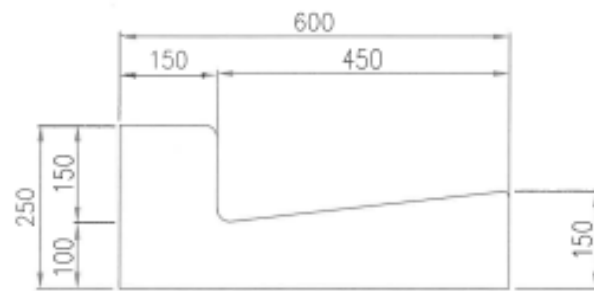

BSC STANDARD BARRIER K&C PROFILE  
Scale - 1:10

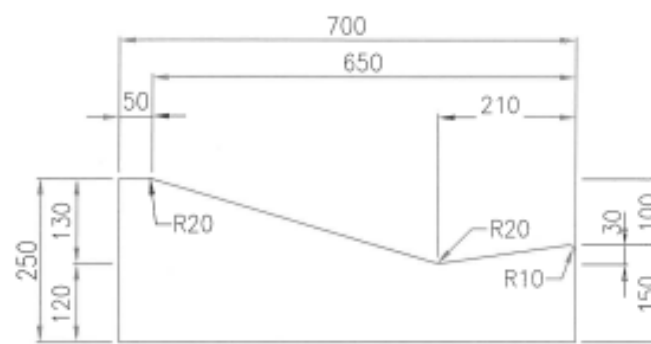

BSC STANDARD LAYBACK K&C PROFILE  
Scale - 1:10



BSC NIB PROFILE  
Scale - 1:10

**STANDARD KERB/KERB & CHANNEL PROFILES**  
(Dimensions in millimetres)

APPLICABILITY TABLE							
Council	BSC	CHRC	GRC	IRC	LSC	MRC	RRC
Applicable	Yes	No	Yes	No	No	No	No
Applicable DWG	CMDG-R-060						

REVISIONS	DATE
F IRC ADDED	12/2016
E GRC APPLICABILITY AMENDED	05/2015
D GRC ADDED	11/2014
C MRC ADDED	04/2011
B MESH ADDED TO CONCRETE INVERTS	01/2011
A POST AMALGAMATION REVIEW	01/2010

**DISCLAIMER.**  
The authors and sponsoring organizations shall have no liability or responsibility to the user or any other person or entity with respect to any liability, loss or damage caused or alleged to be caused, directly or indirectly, by the adoption and use of these Standard Drawings including, but not limited to, any interruption of service, loss of business or anticipatory profits, of consequential damages resulting from the use of these Standard Drawings. Persons must not rely on these Standard Drawings as the equivalent of, or a substitute for, project-specific design and assessment by an appropriately qualified professional.

**Capricorn Municipal Development Guidelines**  
Incorporating:  
Banana Shire Council (BSC) Livingstone Shire Council (LSC)  
Central Highlands Regional Council (CHRC) Maranoa Regional Council (MRC)  
Gladstone Regional Council (GRC) Rockhampton Regional Council (RRC)  
Isaac Regional Council (IRC)

**STANDARD KERB AND CHANNEL PROFILES**

ROADS
STANDARD DRAWING CMDG-R-060A
REV.   A   B   C   D   E   F

Attachment 4

Department of Transport and Main Roads, MTRC, (July 19)

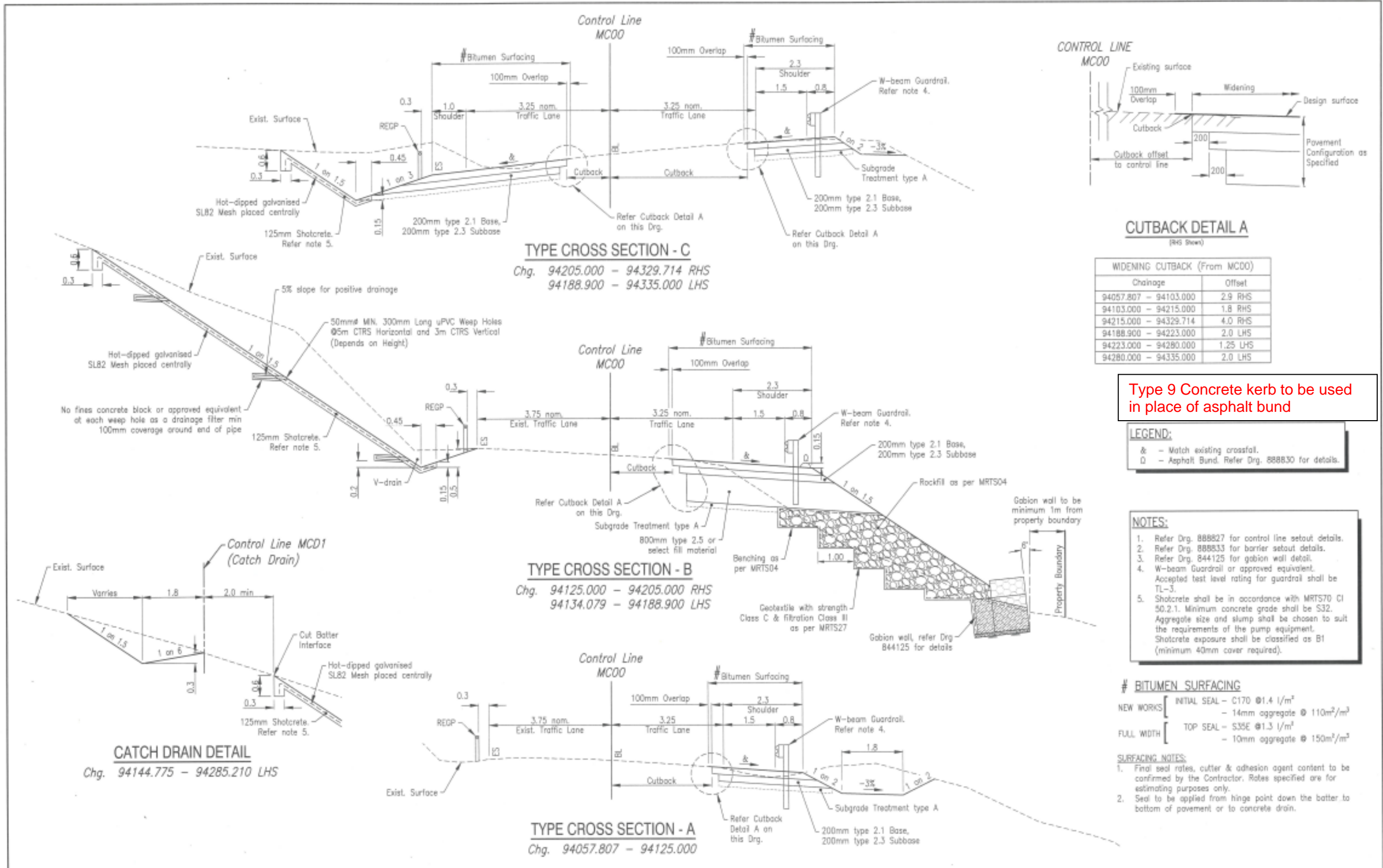

Type 9 Concrete kerb to be used in place of asphalt bund

Associated Job Nos		Survey Data		Scales		BANANA SHIRE COUNCIL		CRACOW RANGE		Queensland Government
Auxiliary Drg Nos		Horiz. Datum: GDA94		0 1.0 2.0m		454 EIDSVOLD - THEODORE ROAD		TYPE CROSS SECTION		
A Issued For Construction		Horiz. Grid: MGA94 Zone56		Dimensions shown in metres except where shown otherwise		CTL CHGE 94.05 - 94.32		ENGINEERING CERTIFICATION (RPEQ)		Job No. 204/454/1983760
Revisions/Descriptions		Height Datum: AHD Derived				Reference Points		Drawn: R. Newlan		Contract No. CN-17272
Name or RPEQ No.		Survey Books: MR102924				Preceding RP: 454/7		Designed: R. Newlan		Drawing No. 888826 A
Signature						Dist. to start of job (km): 5.2		No. 16243		Date: 24/02/21
Date						From end of job: 0.27		DATE		
						From and to Following RP: 16.6				
						Following RP: 454/8				
						Through Chainage from Eidsvold				
										Series Number: TC-01 of 02



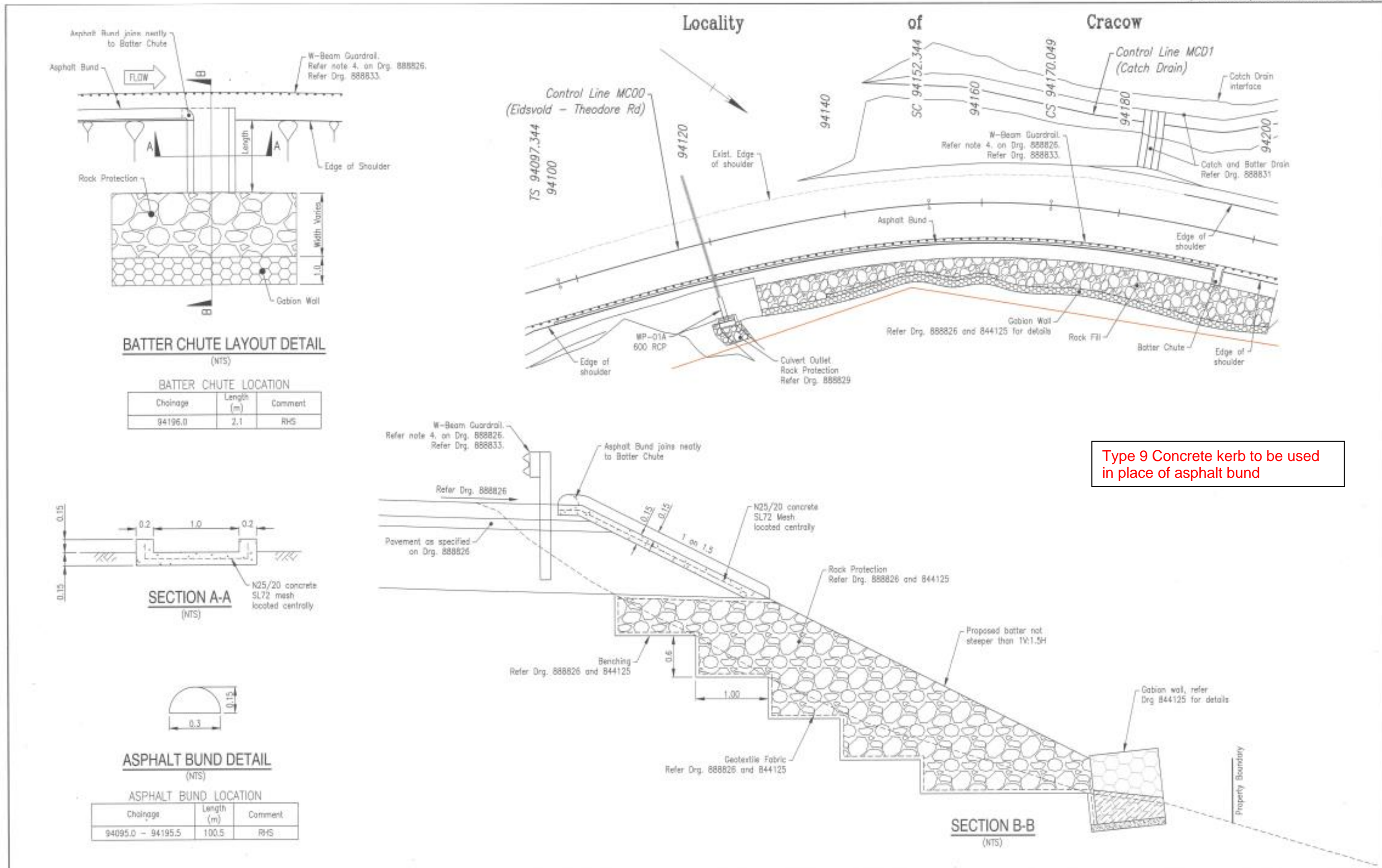

Type 9 Concrete kerb to be used in place of asphalt bund

D E F G H I J K L M N O P Q R S T U V W X Y Z AA AB AC AD AE AF AG AH AI AJ AK AL AM AN AO AP AQ AR AS AT AU AV AW AX AY AZ BA BB BC BD BE BF BG BH BI BJ BK BL BM BN BO BP BQ BR BS BT BU BV BW BX BY BZ CA CB CC CD CE CF CG CH CI CJ CK CL CM CN CO CP CQ CR CS CT CU CV CW CX CY CZ DA DB DC DD DE DF DG DH DI DJ DK DL DM DN DO DP DQ DR DS DT DU DV DW DX DY DZ EA EB EC ED EE EF EG EH EI EJ EK EL EM EN EO EP EQ ER ES ET EU EV EW EX EY EZ FA FB FC FD FE FF FG FH FI FJ FK FL FM FN FO FP FQ FR FS FT FU FV FW FX FY FZ GA GB GC GD GE GF GG GH GI GJ GK GL GM GN GO GP GQ GR GS GT GU GV GW GX GY GZ HA HB HC HD HE HF HG HH HI HJ HK HL HM HN HO HP HQ HR HS HT HU HV HW HX HY HZ IA IB IC ID IE IF IG IH II IJ IK IL IM IN IO IP IQ IR IS IT IU IV IW IX IY IZ JA JB JC JD JE JF JG JH JI JJ JK JL JM JN JO JP JQ JR JS JT JU JV JW JX JY JZ KA KB KC KD KE KF KG KH KI KJ KK KL KM KN KO KP KQ KR KS KT KU KV KW KX KY KZ LA LB LC LD LE LF LG LH LI LJ LK LL LM LN LO LP LQ LR LS LT LU LV LW LX LY LZ MA MB MC MD ME MF MG MH MI MJ MK ML MN MO MP MQ MR MS MT MU MV MW MX MY MZ NA NB NC ND NE NF NG NH NI NJ NK NL NM NO NP NQ NR NS NT NU NV NW NX NY NZ OA OB OC OD OE OF OG OH OI OJ OK OL OM ON OO OP OQ OR OS OT OU OV OW OX OY OZ PA PB PC PD PE PF PG PH PI PJ PK PL PM PN PO PP PQ PR PS PT PU PV PW PX PY PZ QA QB QC QD QE QF QG QH QI QJ QK QL QM QN QO QP QQ QR QS QT QU QV QW QX QY QZ RA RB RC RD RE RF RG RH RI RJ RK RL RM RN RO RP RQ RR RS RT RU RV RW RX RY RZ SA SB SC SD SE SF SG SH SI SJ SK SL SM SN SO SP SQ SR SS ST SU SV SW SX SY SZ TA TB TC TD TE TF TG TH TI TJ TK TL TM TN TO TP TQ TR TS TT TU TV TW TX TY TZ UA UB UC UD UE UF UG UH UI UJ UK UL UM UN UO UP UQ UR US UT UU UV UW UX UY UZ VA VB VC VD VE VF VG VH VI VJ VK VL VM VN VO VP VQ VR VS VT VU VV VW VX VY VZ WA WB WC WD WE WF WG WH WI WJ WK WL WM WN WO WP WQ WR WS WT WU WV WW WX WY WZ XA XB XC XD XE XF XG XH XI XJ XK XL XM XN XO XP XQ XR XS XT XU XV XW XX XY XZ YA YB YC YD YE YF YG YH YI YJ YK YL YM YN YO YP YQ YR YS YT YU YV YW YX YZ ZA ZB ZC ZD ZE ZF ZG ZH ZI ZJ ZK ZL ZM ZN ZO ZP ZQ ZR ZS ZT ZU ZV ZW ZX ZY ZZ	Associated Job No. Survey Data Horiz. Datum: GDA94 Auxillary Drg No. Horiz. Grid: MGA84 Zone58 Height Datum: AHD Derived Survey Book: MR102924	Scale 0 2 4 6 8 10m Dimensions shown in metres except where shown otherwise	<b>BANANA SHIRE COUNCIL</b> <b>454 EIDSVOLD - THEODORE ROAD</b> <b>CTL CHGE 94.05 - 94.32</b> Reference Points Preceding RP: 454/7, Dist. to start of job (km): 5.2, From start to end of job: 0.27, From end to following RP: 16.6, Following RP: 454/8 Through Chainage from EIdavold	<b>CRACOW RANGE DRAINAGE DETAILS</b> Drawn: R. Newton Designed: R. Newton ENGINEERING CERTIFICATION (RPEQ) ENG. AREA: CIVIL, NAME: Faruk Hassali, SIGNATURE: [Signature], No.: 18243, DATE: 24/12/21	 Job No. 204/454/1983760 Contract No. CN-17272 Drawing No. 888830 A Series Number 00-02 of 03
---	--	---	--	--	--

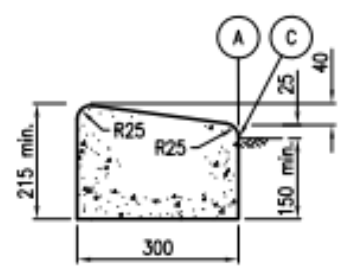

BELOW ROAD SURFACE  
TYPE 1

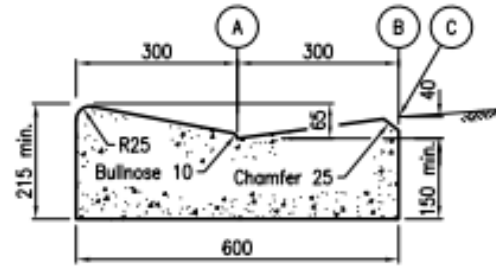

WITH CHANNEL  
TYPE 2

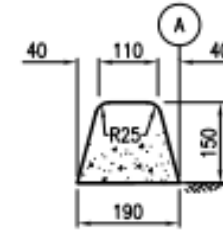

ON ROAD SURFACE  
TYPE 4

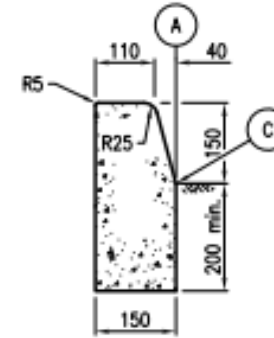

BELOW ROAD SURFACE  
TYPE 5

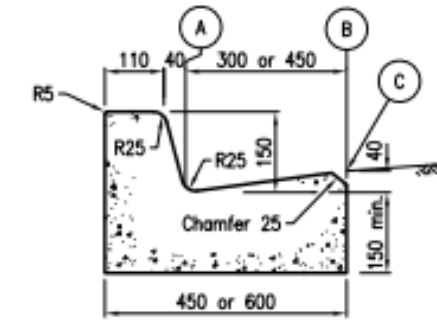

WITH CHANNEL  
TYPE 6 (300 CHANNEL)  
TYPE 7 (450 CHANNEL)

**MOUNTABLE KERBS**

**BARRIER KERBS**

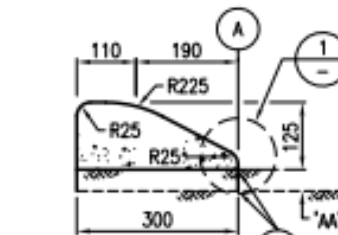

ON ROAD SURFACE  
TYPE 8 (DEPTH 125)  
TYPE 9 (DEPTH 125 + 'AA')

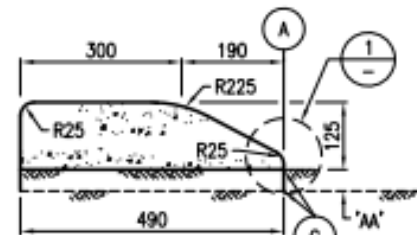

ON ROAD SURFACE - WITH BACKING STRIP  
TYPE 10 (DEPTH 125)  
TYPE 11 (DEPTH 125 + 'AA')

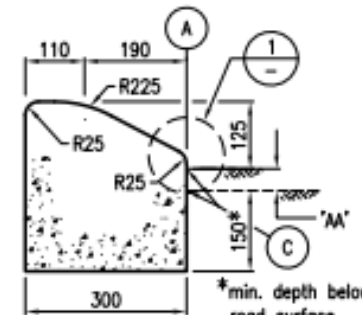

BELOW ROAD SURFACE  
TYPE 12 (DEPTH 125)  
TYPE 13 (DEPTH 125 + 'AA')

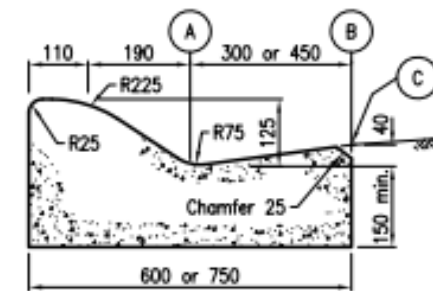

WITH CHANNEL  
TYPE 14 (300 CHANNEL)  
TYPE 15 (450 CHANNEL)

**SEMI MOUNTABLE KERBS**

'AA' Refer Note 4.

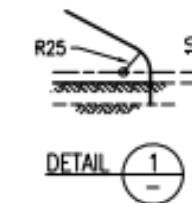

**REFERENCE POSITIONS**

- (A) Line of kerb
- (B) Line of channel lip
- (C) Height reference

**NOTES:**

1. CHANNEL THROAT THICKNESS of 150mm and portion of kerbs below finished surface shown is a minimum. The underside of the section should preferably coincide with the top of a pavement layer in level and slope.
2. TRANSITIONING between kerb types to be carried out over 1.5m (min).
3. CONCRETE
  - Manually placed concrete to be N32/10, to MRTS70.
  - Machine-placed concrete to MRTS70, Clause 17.20, minimum cementitious content of 320 kg/m<sup>3</sup> (no compressive strength testing required).
4. ASPHALT ALLOWANCE 'AA' provides for initial asphalt layer and/or future overlay as indicated in the documents. 'AA' may include the thickness of any combination of: - asphalt corrector course - initial asphalt layers - estimated future asphalt overlay.
5. DIMENSIONS are in millimetres unless shown otherwise.

**ASSOCIATED DEPARTMENTAL DOCUMENTS:**

- Standard Drawings
- Specifications

**REFERENCED DOCUMENTS:**

- Departmental Specifications:
- MRTS03 Drainage, Retaining Structures and Protective Treatments
- MRTS70 Concrete

**Australian Standards:**

- AS 2876 Concrete Kerbs and Channels (Gutters) - Manually or Machine Placed

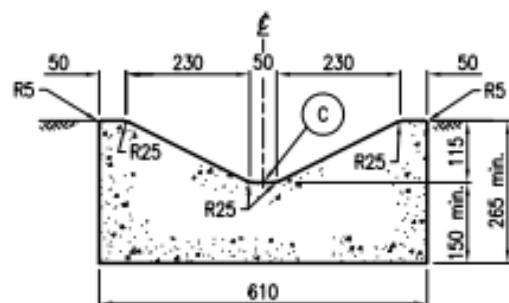

TYPE 3

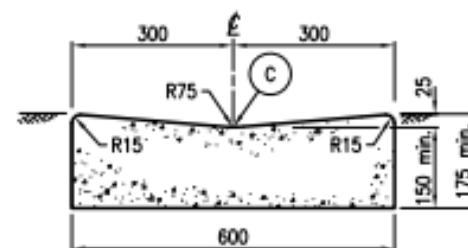

TYPE 22

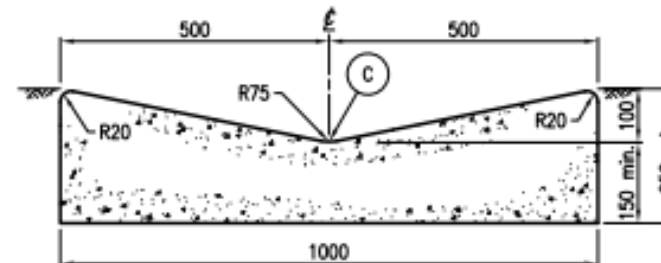

TYPE 28

**CHANNELS**

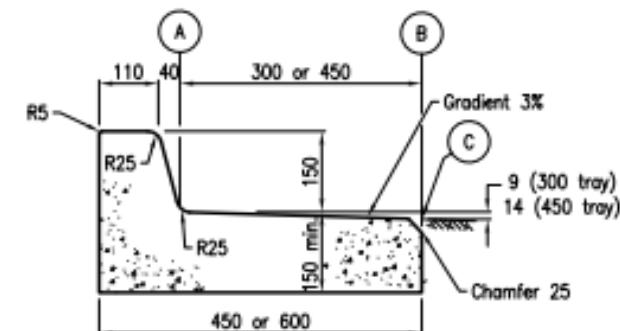

TYPE 23 (300 TRAY)  
TYPE 24 (450 TRAY)

**BARRIER KERB AND TRAY**

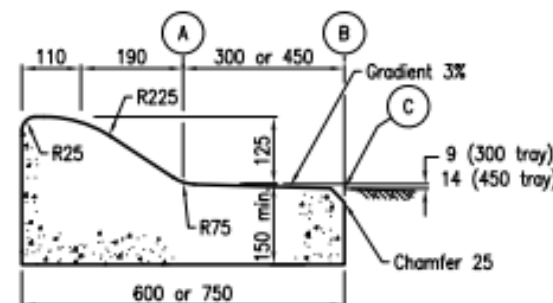

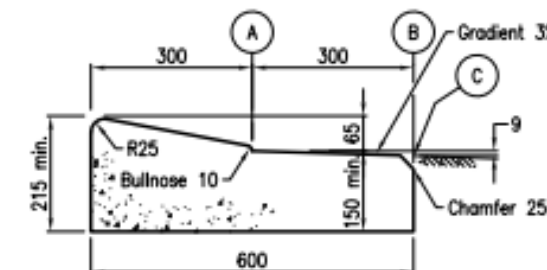

TYPE 25 (300 TRAY)  
TYPE 26 (450 TRAY)

**SEMI MOUNTABLE KERB AND TRAY**



TYPE 27

**MOUNTABLE KERB AND TRAY**

Department of Transport and Main Roads			
KERB AND CHANNEL			
PROFILES		A3	Standard Drawing No
		Not to Scale	1033
			Date 7/2020